



**NOTIFICATION TO ATTEND MEETING OF THE SOUTH EAST AREA COMMITTEE
TO BE HELD IN THE COUNCIL CHAMBER, CITY HALL, DAME STREET, DUBLIN 2.
ON MONDAY 11 DECEMBER 2017 AT 3.00 PM**

AGENDA

MONDAY 11 DECEMBER 2017

PAGE

1	Presentation by Office of Public Works on Plans for the Iveagh Gardens	
2	Presentation: Traffic Advisory Group Update	
3	Minutes of South East Area Committee Meeting held on 13th November 2017	3 - 36
4	Environment and Transportation Department Matters	37 - 44
	i. Traffic Advisory Group minutes of meeting held on 28 th November 2017.	
5	Planning and Property Management Department Matters	45 - 46
	i. Report on proposed disposal of fee simple in a plot of land at rear 1 Eglinton Road to Martaban DAC.	
6	South East Area Office Matters	47 - 64
	i. Update on Community Development, Environmental Services Unit, Housing Projects & Local Area Improvements and Sports & Recreation Sections.	
	ii. Report on naming and numbering proposal for a development at Mount Tallant Avenue.	
	iii. Report on naming and numbering proposal for a development and associated plaza at Dame Street (former Central Bank).	
7	Motions	65 - 68
8	Questions to the Chief Executive 11th December 2017	69 - 78

MINUTES OF THE SOUTH EAST AREA COMMITTEE MEETING

HELD ON MONDAY 13 NOVEMBER 2017

1 **Minutes of South East Area Committee Meeting held on 9th October 2017**
Order: Agreed.

2 **Culture, Recreation and Economic Services Department**

- i. Report on proposed Part 8 works in Temple Bar Square.
Order: Agreed to recommend to City Council.
- ii. Report on shelter in Herbert Park.
Order: Noted.
- iii. Report on extension of playground in Herbert Park.
Order: Noted.
- iv. Ranelagh Gardens Park planting report.
Order: Noted.

Matters raised:

Cllr. Lacey proposed the following motion, which was agreed by the committee:

“In relation to the development of Temple Bar Square this committee requests that the manager gives a commitment to present a report on future seating plans for the area to a meeting of this area committee prior to any proposal being presented to the traders.”

The councillors agreed that this did not form part of the current Part 8 process.

3 **Planning and Property Development Department Matters**

- i. Report on proposed disposal of lease of offices and basement car park at Joshua Dawson House, Dawson Street, Dublin 2 to Irish Clearing House Limited.
Order: Agreed to recommend to city council.
- ii. Presentation on planning application 4038/17 St. Pancras Works, Mount Tallant Avenue, Terenure, Dublin 6W.
Order: Noted. Councillors requested to have their objections to this planning application recorded and were advised that any observations or recommendations cannot be taken into account in the determination of the planning application unless formally submitted in accordance with the provision of the Planning and Development Regulations.
- iii. Presentation on planning application 4040/17 Kavcre, St. Clare's Convent, Harold's Cross Road, Harold's Cross, Dublin 6.
Order: Noted. Councillors requested to have their objections to this planning application recorded and were advised that any

observations or recommendations cannot be taken into account in the determination of the planning application unless formally submitted in accordance with the provision of the Planning and Development Regulations.

- iv. Presentation on planning application 4041/17 Crekav, Mount Argus, Kimmage Road, Harold's Cross, Dublin 6W.

Order: Noted. Councillors requested to have their objections to this planning application recorded and were advised that any observations or recommendations cannot be taken into account in the determination of the planning application unless formally submitted in accordance with the provision of the Planning and Development Regulations.

Cllr. Freehill proposed the following motion, which was seconded by Cllr. Lacey and agreed by the committee:

That a special meeting be held with Rathmines Rathgar Area in Planning Department to discuss the urgency of commencement of Local Area Plan (LAP).

4 **South East Area Matters**

- i. Update on Community Development, Environmental Services Unit, Housing Projects & Local Area Improvements and Sports & Recreation Sections.

Order: Noted.

- ii. Report on naming proposal for a development to the rear of 31 Rathmines Road Lower, The Brambles, 1 – 2.

Order: Agreed.

5 **Motions**

Motion 1 from Councillors Paddy McCartan and Frank Kennedy

(Carried from September South East Area Committee meeting.)

That this area committee supports the following proposal for the resolution of serious safety issues arising from traffic / parking management and the hazards of legally and illegally parked vehicles being encountered at present on Bloomfield Avenue-the public vehicular access to the Royal Hospital, Donnybrook.

The hospital requires 24/7 access for ambulances and fire tenders in case of emergencies. Recently, there has been a significant increase in on-street parking on Bloomfield Avenue. When on-street parking is fully utilised, only one vehicle can use the avenue at any one time as there is insufficient space for two vehicles to pass on the remaining roadway.

In addition; since construction work began at Bloomfield House; there have been numerous occasions when large commercial / construction vehicles completely blocked access to and from the hospital. The hospital management notified the Gardaí when illegal parking took place and liaised on a regular basis with the site manager of the construction company to ensure the roadway was kept clear. Notwithstanding these efforts, there continues to be blockages regularly. The hospital is also conscious that construction work is likely to commence in the near future on the St. Mary's, Donnybrook site also on Bloomfield Avenue.

The Royal Hospital requests that Bloomfield Avenue be designated as a no

parking zone on the left hand side of the avenue from Morehampton Road to the entrance of the hospital. This is particularly important to ensure that emergency vehicles can access the hospital expeditiously, which, if met by oncoming traffic is impossible at present.

Order: Report to councillor.

Motion 2 from Councillor Dermot Lacey

This committee requests a detailed report on each of the points raised in the submission attached to this motion in relation to the planning issues surrounding the Opium pub at 26 Wexford Street and 1a Liberty Lane.

1. In respect of point 1 (planning permission register reference no. 6790/07) levy related inspection back in 2013 indicating that the permission was substantially implemented prior to its expiry and that the structure now completed is in substantial compliance with the permission granted in 2008: This would not appear to be correct, and nearby neighbours are adamant that this development was not carried out or completed in 2013, and by way of sworn statutory declaration and evidence from Google maps, it would appear therefore that 6790/07 would be out of time now. If that is the case then this recent development would indeed be illegal. We would now request a copy of the said levy related inspection, as it would be a most serious matter if this were found to be illegitimate. We would urge the enforcement department to declare the works recently undertaken in relation to 6790/07 to be an illegal development.
2. In respect of point 2, the scope of the illegal activity in this case extends to well beyond the roof, and in fact the original small smoking area has now been developed into a night club which is clearly evident to the planning department. We would like to know how the Planning Department can have overlooked such a major development.
3. In respect of point 3 of the notice and this sworn statutory declaration which has been submitted by one of the owners of the premises indicating that the ground floor of 37 Camden Row was in storage use ancillary to the main premises in excess of seven years. We would request a copy of that declaration. Neighbours are prepared to countermand that with several sworn declarations that No. 37 was being used originally as a sign shop and more recently as a carpentry workshop only, and was in no way ancillary to the Opium super pub. In this case we request the planning department to declare the redevelopment of No. 37 (a beer storage / cooling area with direct connections to Opium), as illegal.

Order: Report to councillor.

Motion 3 from Councillor Mary Freehill

Following discussion at the September Arts & Culture Strategic Policy Committee (SPC) regarding making Grand Canal Walkway safe for pedestrians and cyclists that this local area committee urgently arranges a meeting with Waterways Ireland and appropriate Dublin City Council (DCC) personnel to discuss how they will make the area safe in the immediate future. Furthermore, that we also discuss the path repair work needed along the pathway especially from Charlemont to Leeson Street Bridge.

Order: Agreed.

Motion 4 from Councillor Mary Freehill

That the South East Area Committee arranges a meeting with Traffic Department,

Dublin Bus and Dublin Transport Authority to discuss the arrangements that need to be put in place for the restoration of the 140 and 15 bus routes via St. Stephen's Green, which was promised on completion of the LUAS works on Dawson Street.

Order: Agreed.

Motion 5 from Councillor Dermot Lacey

This committee requests the manager to discuss with the local residents' association the possibility of installing a bike shed at Beech Hill Villas as suggested in the email attached and further requests that the gaps in the fence and gate that were to be repaired last summer would actually be repaired.

Order: Report to councillor.

Motion 6 from Councillor Mary Freehill

That the manager informs us of the number of

- a) engineering staff including grades
- b) administrative staff including grades

in Road Maintenance and Traffic Department. (These figures to be given separately for each department) also to compare staffing levels in 2008 and current level. What vacancies currently exist in each department and for how long?

This can be discussed at the November meeting.

Order: Report to councillor.

Motion 7 from Councillor Dermot Lacey

This committee agrees to locate two "Welcome to Portobello" signs similar to those being installed in other villages such as Donnybrook, Ranelagh and Sandymount, at appropriate entrances to the area to be agreed with local residents.

**Order: Motion amended to read "three "Welcome to Portobello" signs".
Report to councillor.**

Motion 8 from Councillor Dermot Lacey

This committee requests the manager to examine the possibility of installing a small playground in the Portobello Harbour as suggested below.

In the area in front of the Lower Deck pub there were previously at that location a swing, slide, see-saw etc, so it was a playground before it was the "urban park" now. Not all of the area there, just a corner of it would be fine for a playground).

Order: Report to councillor.

Motion 9 from Councillor Dermot Lacey

This committee requests the manager to ensure a major upgrade to the roadway on Morehampton Lane, Donnybrook which is in an appalling state. This road, previously a relatively quiet road, is now home to a full street of houses. It may be possible to carry out these works in conjunction with major development at far end of the road currently underway.

Order: Report to councillor.

Motion 10 from Councillor Mannix Flynn

That this committee of the South East Area calls on Dublin City Council to reinstate the coordinators for South East Area safety forum meetings and drug task force immediately. A number of years back, due to cuts, we lost coordinators here who were vital to the running of these services for community. With the

upsurge in anti-social behaviour and criminality on our streets and illegal drug use it is time to reinstate the coordinators for this vital work.

Order: Report to councillor.

Motion 11 from Councillor Mannix Flynn

That this meeting of South East Area calls on the Planning Department of Dublin City Council to reflect, in writing, the agreement that took place with regards the inclusion of mixed creative use and film studio in the SDZ Poolbeg Planning Scheme. The present document does not reflect the statement that was made by Mr John O Hara that the film studios and other creative use would be given equal parity with the Dublin Port Company's plan and vision. At present the document appears to be prejudiced and slightly skewed towards port only development in principal.

Order: Agreed.

Motion 12 from Councillor Mannix Flynn

That this committee of the South East Area calls on Dublin City Council Housing Department to purchase, off the plans, the remaining apartments that are to be built in the Charlemont Street rejuvenation project. It is important that we now lay claim to these apartments and purchase them at the reduced rate given what we know, that we will still be in a public housing shortage and crisis over the next number of years. This is an opportunity to invest in the future of our citizens' housing needs and there should be no hesitation with regards this matter given the fact that in one year alone, we spent over 7 million Euros with just one hotel group accommodating people who were homeless.

Order: Agreed.

Motion 13 from Councillor Mannix Flynn

Given that Dublin City council tenants are to be charged a management fee with regards the apartment blocks they are housed in that this committee recommends that those same tenants be given the opportunities to serve on the management boards of those apartments. This is in keeping with the law and in keeping with best practice elsewhere. This would include all private apartment complexes and apartment blocks that are owned by approved housing bodies. This would be a strong move of inclusion, equality and democratic participation.

Order: Agreed.

Motion 14 from Councillor Paddy McCartan

That the area committee expresses its dismay at the halting of the school building project for St. Christopher's Primary School, Haddington Road. The 24 classroom co-educational was due to open for the new school year last September. Parents of the children have been told that it will take a further two years to complete the project. While the taxpayer will inevitably foot the bill, the main losers in this whole debacle are the boys and girls who are currently crammed into pre-fabs.

Order: Agreed.

Motion 15 from Councillor Claire Byrne

That this area committee agrees that the Pigeon House site and adjacent buildings and land owned by Dublin City Council will be used only for community, cultural, creative and artistic purposes, and that Dublin City Council will actively pursue the development the Pigeon House site as a community, creative and artistic cluster and will work in collaboration with suitable partner (s) and in consultation with the Arts Office, Arts and Culture Recreation SPC and the area committee and Dublin City Council and that the area committee will not support any development proposals that do not adhere to the above.

Order: Motion deferred.

Motion 16 from Councillor Claire Byrne

That this area committee calls on the area manager to immediately cease the removal of trees from along The Grand Canal, asks her to outline the reasons why there were a number of trees and willow recently removed from the Grand Canal close to where new developments are taking place, who proposed the removal of the trees, whether there was any public consultation regarding the removal of the trees, who authorised this and who carried out the work.

Order: Report to councillor.

Motion 17 from Councillor Claire Byrne

That this area committee calls on the area manager to introduce traffic calming measures for Emorville Avenue, St. Kevin's Parade and Lombard Street West, Portobello, Dublin 8. These streets are regularly used as a rat run during peak hours with cars travelling at high speed through the area. Measures could include the use of planters as a traffic calming measure, which have worked well in other parts of Portobello and increasing the number of 30km/ph signs in the area.

Order: Report to councillor.

Motion 18 from Councillor Claire Byrne

That this area committee agrees to provide a Christmas tree in Portobello Harbour or a similar location on the Portobello area for this coming Christmas.

Order: Report to councillor.

6 **Questions to the Chief Executive 13th November 2017**

Order: Noted.

Councillor Paddy McCartan

Chairperson

Monday 13 November 2017

Attendance:

Members:

Paddy McCartan
(Chairperson)
Chris Andrews
Anne Feeney
Frank Kennedy
Claire O'Connor

Members:

Kieran Binchy
Mannix Flynn
Dermot Lacey
Paddy Smyth
Michael Mullooly

Members:

Claire Byrne
Mary Freehill
Ruairi McGinley
Sonya Stapleton

Officers

Mark Ginnetty
Paul McCann
Michael Noonan
Brian Kirk
Declan Wallace

Brian Hanney
Rose Kenny
Les Moore
Fidelma Fahey

Leah Johnston
Fiona O'Brien
Jennifer Wall
Eileen Martin

Apologies:

Non-Members:

Q1. Councillor Ruairí McGinley

To ask manager to reinstate park bench at *details supplied.

Reply:

This area has now been cleared and will be reinstated shortly.

Q2. Councillor Ruairí McGinley

To ask the manager when footpath renewal on Upper Rathmines Road is scheduled.

Reply:

Upper Rathmines Road is not on our planned footpath renewal works. It will be logged in our Asset Management System for local repair works to be carried out.

Q3. Councillor Ruairí McGinley

To ask the manager to carry out following work *details supplied.

Reply:

1. Material in behind railings could not be identified at any place along this lane.
2. There was no skip in the laneway on the day of inspection.
3. The abandoned car referred to was not in the laneway at time of inspection.
4. If the councillor could specify the exact building, the matter will be investigated.

Q4. Councillor Dermot Lacey

To ask the manager if she will, in recognition of the great work of the Donnybrook Residents' Association at this location, arrange for the large tree overreaching onto and over the footpath from the Dublin City Council owned garden to the side of 29 Home Villas, to be seriously pruned and to arrange for the weathered but of heritage value road sign post for Auburn Road attached to the railings under that same tree to be repainted in the traditional style.

Reply:

Road Maintenance Services Division is not in a position to repair existing nameplate but can arrange for a new one to replace it.

Arrangements have been made to have the tree pruned back and excess vegetation removed.

Q5. Councillor Paddy Smyth

To ask the manager to request that Dublin Bus return the No. 140 to its original route prior to the Luas Cross City works, so that children from the Rathgar-Rathmines, who attend Loretto, C.U.S. and The Institute of Education can be dropped to a bus stop within safe walking distance to their school as was the case previously.

Reply:

The issue of bus routes and where they are regulated to operate is a matter for the National Transport Authority and not Dublin City Council.

Q6. Councillor Paddy Smyth

Given the serious lack of parking available to residents in Summerville Park, Rathmines, is it possible to have the 29 spaces marked out, to ensure more efficient parking?

Reply:

It is not the council's policy to mark individual spaces in residential parking schemes as to do so is not practicable due to parked cars, would involve increased costs and it is the council's experience that to do so would actually reduce the number of available spaces especially if buffer zones are included. Residential parking zones in the city are marked in accordance with RRM 016 - direction of the Minister for Transport under Section 95 (16) of the Road Traffic Act 1961 (i.e. parallel parking bays with no individual bays).

Q7. Councillor Anne Feeney

To ask the manager, to review the trees and footpaths at Mount Argus Grove, Harold's Cross as they are in a bad state and some residents have fallen on them. (One claim currently being processed by Dublin City Council).

Reply:

The footpaths at this location are logged in our Asset Management System for local repair works to be carried out.

The trees in Mount Argus Grove have been inspected and are in good condition overall. They would not be prioritised for major pruning at the present time.

Q8. Councillor Anne Feeney

To review the granting of parking permits to residents of Terenure Road North to park on Eaton Road as there are insufficient spaces on Eaton Road for residents of the road.

Reply:

There is considerable demand for parking throughout the area with the majority of roads being at or close to full capacity. The inclusion of an additional road on any permit is therefore restricted and tightly controlled by the city council and considered strictly on a case by case basis. Permits issued to residents of Terenure Road North that also include Eaton Road have been issued strictly in accordance with the Dublin City Council Parking Control Bye-Laws, i.e. "the applicant's normal dwelling place is at a building situated on a road which is adjacent to a residential parking permit road and to which the permit will relate and where the parking of vehicles on the applicant's road is significantly restricted by parking controls".

Parking on Terenure Road North is severely restricted due to the presence of a cycle track / bus lane / clearway at certain times during the day with residents prevented from parking during that time. Resident permit holders have therefore been facilitated with resident parking permits that are valid for an adjoining road in addition to Terenure Road North.

There are thirty-nine parking spaces on Eaton Road with thirty-one parking permits in total issued that can be used on the road. This includes six permits issued to residents of adjoining roads that have been facilitated with Eaton Road as a second valid road on their permit with three of those being residents of Terenure Road East.

Q9. Councillor Anne Feeney

To ask the manager to prune the trees at the corner of York Avenue and York Road as they appear to be overhanging into nearby properties and are dangerously top-heavy as autumn approaches.

Reply:

The trees at this location were inspected and noted to be mature lime trees (*Tilia* spp.) in good condition with no damage visible as a result of the recent storm. It is recommended that branches extending into private property will be pruned back. This work will be included as part of our tree works programme and subject to available funding will be undertaken on a priority basis in 2018.

Q10. Councillor Anne Feeney

To ask the manager to consider putting a 'Stop' sign at the junction of Clareville Road with Kenilworth Park.

Reply:

This request has been added to the Traffic Advisory Group agenda for examination and report by the Area Traffic Engineer. The councillor will be informed of the recommendation in due course.

Q11. Councillor Anne Feeney

To ask the manager to arrange for the removal of graffiti from the Protected Studio structure of Sarah Purser (famous portrait artist 1849-1943) on Harcourt Terrace.

Reply:

The graffiti referred to in this case is on private property and is on the side wall of no. 11 Harcourt Terrace, which is actually on Charlemont Place. It is obvious that the owner / occupier painted this wall recently enough and the South East Area Office will contact them in relation to this matter as it is their responsibility as regards removal of this graffiti.

Q12. Councillor Anne Feeney

To ask the manager to arrange for double yellow lines to be placed on Garville Lane, opposite to houses as parked cars are making it very difficult for residents and potentially difficult for emergency service vehicles.

Reply:

The request for double yellow lines on Garville Lane opposite the houses has been referred to the Traffic Advisory Group for examination and report. The councillor will be informed of the recommendation in due course.

Q13. Councillor Dermot Lacey

To ask the manager if she will arrange to have an examination of Williams Place - off Clanbrassil Street to deal with:

1. The dumping of rubbish at the end of Williams Place the corner needs to be blocked off
2. Road needs resurfacing
3. Paths badly need replacing
4. Dublin City Council (DCC) houses need painting and outside wall cracks filled in
5. The street needs to be de-weeded lots of weeds
6. The big tree outside no. 37 needs to be removed just yesterday 2 trees fell they were only 20ft ones
7. No.13 DCC needs to contact the owner as it went on fire
8. The building belonging to the Meath Hospital has holes in the roof. It looks like it is an abandoned building. The boundary wall needs looking at.

Reply:

1. The rubbish will be removed.

2. & 3. The road and footpaths here are not on our planned road resurfacing/footpath renewal works. They will be logged in our Asset Management System for local repair works to be carried out.
4. Housing Maintenance Section engineers will investigate this matter and will take appropriate action if cracks are deemed to be of a structural nature. It is Dublin City Council's policy to paint flat complexes and senior citizen complexes only. The responsibility for the external upkeep and painting of houses lies with the tenant.
5. Waste Management Services had weeds cleared from Williams Place on the 18th October 2017.
6. The Street tree outside House Number 37 is scheduled for removal as part of the winter 2017/18 programme of works.
7. Dublin City Council Dangerous Buildings Section is familiar with this premises at 13 Williams Place South, Dublin 8, having attended to same & re-secured post fire 19/09/2017. Further to routine inspection 18/10/2017, the Dangerous Buildings Inspector noted the premises remains secure & no further action warranted at this time. The Dangerous Buildings Section is seeking title ownership of the premises to serve a **DB1 Notice** & pursue under remit of the **Local Authority Sanitary Services Act 1964**.
8. The Meath Hospital premises, boundary wall & fencing, is currently deemed secure and poses no danger to the general public; no further action warranted at this time. The Dangerous Buildings Inspector for the area will continue to periodically monitor, as is our remit under the above mentioned Act.

Q14. Councillor Paddy Smyth

To ask the manager when Ranelagh Road, or parts thereof, is scheduled to be resurfaced.

Reply:

Ranelagh Road is not on our planned road resurfacing works programme. It will be logged in our Asset Management System for local repair works to be carried out.

Q15. Councillor Dermot Lacey

To ask the manager if the trees in the Arranmore Road, Argyle Road area be investigated for appropriate action especially the trees on Arranmore Road are particularly overgrown. Both the actual branches which are hanging quite low at eye level but also the bases of the trees that have become very untidy.

Reply:

The tree pruning request for Arranmore Road and Argyle Road will be included in our tree pruning programme for the district and will be undertaken after leaf fall, over the coming six to eight weeks.

Q16. Councillor Chris Andrews

That the manager facilitates a presentation for councillors at the next area committee meeting regarding the future development plans in place for the Iveagh Gardens.

Reply:

The South East Area Office will write to the Office of Public Works inviting them to make a presentation, as requested.

Q17. Councillor Chris Andrews

Can *details supplied have his flat completely rewired as I believe it is unsafe electrically and it is a health and safety concern?

Reply:

This matter has been referred to Electric Services for their attention.

Q18. Councillor Chris Andrews

Can the manager arrange to have the pedestrian crossing at Mount Street Bridge and Grand Canal Bridge examined from pedestrian safety as I have had a numerous parents contact me with concerns over the difficulty school children coming from the Pearse Street direction to Haddington Road School in the mornings concerned with the danger the cyclists are presenting at these crossings?

Reply:

A review of the traffic signals timings for both pedestrian crossings will be carried out. Changes to the signal operation will be made if deemed appropriate and in order to provide for the needs of all road users.

This is a wide study area, the South East Area Engineer will review it in due course and any enhancements will be considered after reviewing the route from Pearse Street to Haddington Road.

Q19. Councillor Chris Andrews

Can the manager have the serious leaking into the walls of *details supplied repaired as a matter of urgency?

Reply:

Having inspected this property, it was found that the tenant had blocked the air vents resulting in condensation being present in the property. The tenant was advised of the need for proper ventilation. The local Housing Maintenance Depot has agreed to install vent covers providing the tenant unblocks the air vents.

Q20. Councillor Anne Feeney

To ask the Traffic Department to consider putting a traffic mirror on Lower Kimmage Road facing the junction of Casimir Road and Lower Kimmage Road. Because of legal and illegal parking on Lower Kimmage Road to the right as you exit Casimir Road, drivers and cyclists have a very limited view of oncoming cars at this junction.

Reply:

Dublin City Council does not provide traffic mirrors as they give a distorted view of approaching traffic which is potentially hazardous and also because such mirrors would attract a high degree of vandalism with associated maintenance costs. It is illegal to park within 5 m of a corner and if vehicles are doing so then this is an enforcement issue and is a matter for the Gardaí and Parking Enforcement.

Q21. Councillor Anne Feeney

To ask the manager to carry out a review of the number of parking permits issued to residents of Casimir Road and surrounding areas with a view to allowing a maximum of two permits per house and where linked roads have permits to park on Casimir Road, that the residents of Casimir Road are also given permits to park on adjoining roads. Residents in the area have often been unable to park on their own road due to no parking spots remaining and unable to park on adjoining roads as they don't have permits for them. Dublin City Parking Services are very active in clamping on

these roads as is the case right across Harold's Cross and Terenure residential roads.

Reply:

The Dublin City Council Parking Control Bye-Laws regulate with regard to all Pay and Display and Permit Parking Schema and set out entitlement and eligibility to parking permits, including the quota of permits that apply to different dwelling types.

The current bye-laws were made by the elected members in 2014 and set out a change to the quota of permits available to a house, reducing from a quota of three to a quota of two for any new residential parking schemes introduced from that date. Dwellings located in existing schemes retained the previous quota that applied under the previous bye-laws. If the quota was to be reduced for all existing schemes there would be a requirement for a considerable number of residents to surrender their resident parking permits.

There is extremely high demand for parking on all roads in the area and there is no automatic entitlement to inclusion of an additional road on any permit. Nevertheless, the inclusion of an additional road on a permit can be considered by the city council. Applications of this type are considered on a case by case basis taking account of the number of permits already issued for the additional road being sought and the number of parking spaces available on the road.

Q22. Councillor Anne Feeney

To ask the manger *details supplied to request the following information from Dublin Parking Services:

Reply:

- a) Two illegally parked vehicles were clamped on the 2nd October. Due to human error the location of the offence was incorrectly recorded on the ClampIt system.
- b) Both of these have since been refunded in full. There are no circumstances whereby immediate and automatic refund can be authorised as the actions and circumstances that gave rise to the situation must be reviewed by both Dublin Street Parking Services and Dublin City Council.

Q23. Councillor Chris Andrews

Can the manager arrange to fix the guttering at *details supplied, finish the insulation and repair the balcony that is flooding?

Reply:

Contractors have been engaged to replace the guttering and complete the insulation and these should be completed by end of November. An engineer will call to the complex and investigate the balcony flooding and will then make arrangements to have appropriate action taken.

Q24. Councillor Chris Andrews

Can the manager arrange for the leak to the ceiling of *details supplied to be repaired and also a date for the installation of the door which was measured up in October 2016

Reply:

The leak has been repaired at this property. The tenant initially refused the door that was fabricated and offered to her and it was subsequently installed at another property. Another door has been ordered and it should be fitted before mid December.

Q25. Councillor Chris Andrews

Can the manager arrange to have the lamp standard which was recently installed on City Quay close to the seafarers' monument fixed, as it hasn't been working since this lamp standard was erected?

Reply:

These works are being carried out by a public lighting contractor on our behalf. The existing lights are working so there should be no issue with lighting. The old lamp standards cannot be taken down until ESB supplies can be transferred over to the new poles. When ESB supplies are transferred to the new poles, the poles will light. I will ask the contractor to carry out any outstanding works as soon as possible.

Q26. Councillor Chris Andrews

Can the manager arrange to replace a tree that is approximately 90 - 100 feet high and growing no more than 3 metres at the rear of 135 Ringsend Park and its branches overhang 134 and 136 Ringsend Park by 8 - 10 feet. Over the last year and during the recent high winds there has been a noticeable increase in movement and creaking coming from the branches. Residents are extremely worried that if this tree or any part of this tree comes down at any time it could cause serious injury or even death, not to mention a considerable amount of damage and destruction to any of the above properties.

Reply:

The tree in question is a mature Lime tree (*Tilia sps.*) and considered to be in good condition, based on a ground level inspection.

There was no evidence of damaged or broken branches in the crown of the tree resulting from recent storms. This may be due to the good condition of the tree and also to the relatively sheltered location in which it is growing.

The movement of the tree in high winds is a natural protective measure of trees which helps them to strengthen the tree crown and trunk over the life span of the tree. It was observed that there are a number of 'crossing branches' in the tree trunks which would have caused a creaking noise as the tree moved in the wind. However there was no evidence of damage to these branches.

Considering the age, species and location of the tree it is recommended that the height of the tree is reduced by 15 - 20 % and some of the 'crossing branches' be removed or thinned allowing for ease of air flow within the tree crown. The works will also provide an opportunity for a more detailed inspection of the tree crown to take place by an experienced arborist.

This work will be added to our 2018 Tree Works Programme. These works are undertaken on a priority basis over the year subject to available funding.

Leaf litter in the park is currently being collected and this process will continue over the coming weeks until it is all removed or composted in the park.

Q27. Councillor Chris Andrews

Can the manager have the trees blocking the light at *details supplied cut back?

Reply:

Pruning will be carried out at this location to help improve light levels from the street lamps. Work will be carried out over the next four weeks.

Q28. Councillor Chris Andrews

Can the manager have the leaves on and around *details supplied cleared as they are a risk for pensioners out walking.

Reply:

Waste Management Services operates a leaves removal programme during the autumn and winter months. Priority is given to tree-lined streets with heavy pedestrian use and areas particularly prone to flooding. We will ensure that this road is included as often as possible during the course of this programme.

Q29. Councillor Chris Andrews

Can the manager assure residents of Sundrive Park that no gate will be installed into the park through Sundrive Park?

Reply:

Parks and Landscape Services have recommended that an entrance is not installed to Eamonn Ceannt Park from Sundrive Park.

Q30. Councillor Claire O'Connor

That this committee would write to Dublin Bus and ask them to restore the 140 bus route to facilitate children travelling to school.

Pupils attend Loreto Junior School from many parts of the city, north and south and then continue, in the main on to the senior school. In the near vicinity are CUS junior and senior schools and the Institute of Education which caters for pupils of both sexes from 4th year to Leaving Cert. Similarly, pupils at these schools come from all corners of the city.

One of the very suitable bus routes that facilitated attendance at these schools is / was the 140 which travels from Dartry to IKEA via the city centre. Its original route took it along Rathmines Road turning right at the Bleeding Horse pub, and then onto Charlotte Way, Hatch Street and then left onto Earlsfort Terrace and then onto the Green, down Dawson Street and then heading North via Nassau Street and O'Connell street.

Coming south its route was a reverse of the above, save that it followed the one way system of Kildare Street and onto the green and back up Earlsfort Terrace. The stop nearest to the green going into town was at the corner of Earlsfort Terrace and the green and heading south was outside the OPW office on Stephen's Green South. Pupils, when of a suitable age, travelled to school independently on this route, from south and north.

When the works commenced to extend the LUAS green line the route of the 140 was altered and instead of the above it now travels, in both directions along Camden Street, Dame Street and onto O'Connell Street. The nearest point to the green then became the vicinity of the Bleeding Horse pub. To get to the schools listed above this involves crossing a series of very busy streets.

At the time of the alteration of the route Dublin Bus advised that this was a temporary change to facilitate the various works associated with the Luas which seemed very reasonable. However, this has not happened notwithstanding that the LUAS extension trams are now being tested and it is likely that they will go into full passenger service in the run up to Christmas. If the 140 route is to be restored then it seems that decision will have to happen before the service opens to passenger use.

Reply:

The issue of bus routes and where they are regulated to operate is a matter for the National Transport Authority and not Dublin City Council. The National Transport Authority may be contacted at National Transport Authority, Dún Scéine, Harcourt Lane, Dublin 2. D02 WT20, tel.: 879 8300, email: info@nationaltransport.ie

Q31. Councillor Claire O'Connor

Can the manager restore the paid parking on the right hand side just before Gulistan Cottages? This parking was removed for trucks accessing the dump which is closing down now, so the reason has gone for removing those paid parking places.

Reply:

The graffiti in this location is all on private property. Accordingly, it is the responsibility of the owners / occupiers to arrange removal.

Q32. Councillor Claire O'Connor

Can York Road lane be resurfaced?

Reply:

The lane running from York Road to York Avenue, Dublin 6 is not on our planned road resurfacing programme. It will be logged in our Asset Management System for local repair works to be carried out.

Q33. Councillor Claire O'Connor

Can the graffiti at the entrance to Rathmines Park from Rathmines Road Upper be cleaned?

Reply:

Graffiti at this location has been listed for removal.

Q34. Councillor Claire O'Connor

Can outdoor seats or benches or some kind of suitable furniture be made available to the residents of Rathmines Avenue Flats?

Reply:

The Area Housing Manager is currently looking at the feasibility of installing seating and other recreational equipment in this complex with regard to durability, suitability and pricing.

Q35. Councillor Claire O'Connor

Can the trees in Annesley Park be pruned and the footpaths repaired between numbers 3 and 24?

Reply:

The footpath at this location will be logged in our Asset Management System for local repair works to be carried out.

The trees in Annesley Park will be pruned over the coming two to three weeks.

Q36. Councillor Claire O'Connor

Can the manager restore the paid parking on the right hand side just before Gulistan Cottages? This parking was removed for trucks accessing the dump which is closing down now so the reason has gone for removing those paid parking places.

Reply:

The Traffic Advisory Group previously did not recommend reinstatement of the parking at this location on Gulistan Terrace for the following reasons which continue to be relevant;

- Parking spaces were removed and clearways introduced to allow for reasonably safe driving for two-way traffic to and from the Bring centre and to discourage and prevent vehicles mounting the footpath and causing danger to pedestrians as a consequence,
- There is pedestrian access through the Bring Centre from Gulistan Terrace to Rathmines Road Lower which is regularly used by the public, parents, students and school children in the locality,
- There remains a significant number of large vehicles using the Bring Centre, including, Road Sweepers, Grab and Hook Trucks servicing the Bring Centre and General Waste Collectors requiring a safe turning location

Q37. Councillor Claire O'Connor

Can the footpaths on Victoria road be repaired?

Reply:

The footpaths at this location are logged in our Asset Management System for local repair works to be carried out.

Q38. Councillor Claire O'Connor

Does the council propose taking any measures, for example, installing a gate, in respect of the laneway between Centra on Harold's Cross Road and Leinster Place in light of the recent armed robbery in his store?

Also, in respect of the fire at the unused shed beside Leinster Place; can damaged material be cleaned up as a matter of urgency given the roof was made of asbestos material?

Reply:

The laneway adjoining Centra in Harold's Cross leads in to Leinster Place and other residential areas nearby and a public right of way exists over it. The issue of closing off this lane has been raised on various occasions since January 2014 and the support of all local residents and others would be needed to extinguish the public right of way over it. The South East area did consult with local Gardaí when this issue was first raised. The lighting in the laneway was upgraded in 2014. It was also suggested that a "swing gate" at the Harold's Cross end of the laneway be installed. However, our Access Officer recommended against this proposal, because of the narrowness of the lane here, and the fact that such a gate would not be universally accessible in that it would not facilitate people with buggies, wheelchair access, or people with other disabilities. The material referred to beside Leinster Place has been cleaned up.

Q39. Councillor Anne Feeney

To ask the manager to consider removing some of the trees in Mount Drummond Square, Harold's Cross where they have uprooted pavements and consider replacing them with a variety of tree that will not cause these problems into the future.

Reply:

These are young hornbeam trees (*Carpinus* spp.) and it is not considered appropriate to have them removed at this time.

Q40. Councillor Anne Feeney

To ask the manager to ensure enforcement of the 'dogs on leads' rule in Harold's Cross Park at all times as this local park is heavily used by parents with small children and children from the Montessori school nearby and on many occasions dog owners let their dogs loose in it.

Reply:

The manager of the dog pound has been requested to arrange for wardens to patrol the Harold's Cross Park area on a more regular basis. It should be noted that the warden service is limited to three wardens who work

9.00am to 5.00pm	Mon to Fri
9.00 to 3.00 pm	Sat
9.00 to 1.00pm	Sun

Dublin Corporation Bye – Laws make provisions for the control of dogs in certain places. The Bye Laws set out the times during which a dog may be unleashed in a public place. A copy of these Bye laws is available on our website www.dublincity.ie

"A person in charge of a dog in an area specified in the First Schedule to these Bye-Laws [except (a) American Pitbull Terrier, (b) Bull Mastiff , (c) Doberman Pinscher, (d) English Bull Terrier, (e) German Shepherd(Alsatian), (f) Japanese Akita, (g) Japanese Tosa, (h) Rhodesian Ridgeback, (i) Rottweiler, (J) Staffordshire Bull Terrier, and to every dog of the type commonly known as a Ban Dog (or Bandog) and to every other strain or cross of every breed of every type of dog described above] shall keep the dog on sufficiently strong chain or leash, not exceeding two metres in length if a fixed leash, or ten metres if retractable, while in that area, except during the following times when the dog may be unleashed in such areas (but excluding the North Bull Island and any other such area for which a Special Amenity Area Order is made) provided that such dog must still be under the effectual control of the person-in-charge of the dog in accordance with the Control of Dogs Acts, 1986 and 1992:

January & December:	8.00 a.m. - 11.00 a.m.	4.00 p.m. - 5.00 p.m.
February & November:	8.00 a.m. - 11.00 a.m.	4.30 p.m. - 5.30 p.m.
March & October:	8.00 a.m. - 11.00 a.m.	5.30 p.m. - 6.30 p.m. (Wintertime)
	6.30 p.m. - 7.30 p.m. (Summertime)	
April & September:	8.00 a.m. - 11.00 a.m.	7.30 p.m. - 8.30 p.m.
May & June:	8.00 a.m. - 11.00 a.m.	
July & August:	8.30 p.m. - 9.30 p.m.	

Any -

- (a) park,
- (b) garden,
- (c) open space,
- (d) field,
- (e) stadium,
- (f) seashore,
- (g) other place used for outdoor recreational or sporting activities, which is under the control of the Corporation (Dublin City Council).

Q41. Councillor Dermot Lacey

To ask the manager to arrange for a clean-up of Grantham Street as a matter of urgency and to deal with the various problems detailed in the photographs and email text supplied with this question.

Reply:

Waste Management Services had Grantham Place cleaned on the 31st October 2017. The graffiti referred to in Grantham Place is on private property and as such, the responsibility for removal rests with the individual owners / occupiers.

Q42. Councillor Mannix Flynn

Can the manager erect a bollard at the entrance of Dame Lane West at the George's Street entrance? This laneway is used on a regular basis to park trucks and cars. It is now a dangerous situation with cyclists, pedestrians, cars and business owners competing for a small space. It was agreed recently to put double yellow line at this location but really in order to stop illegal dangerous parking a retractable bollard is what is needed. All of the business area's can be serviced from Dame Street or Georges Street.

Reply:

The area engineer recommended double yellow lines on this location. The implementation of this measure will be carried out by the line marking team in due course.

Introduction of bollards on Dame Lane West at the Georges Street entrance are not recommended as it will extinguish the "right of way" of the business properties in this lane. Also access for emergency vehicles and fire services would be affected.

Q43. Councillor Mannix Flynn

Can the manager issue a report with regards the fixing of the carriage way on Sir John Rogerson's quay, this area and roadway is in a deplorable state and needs resurfacing?

Reply:

Sir John Rogerson Quay is not on our planned road resurfacing works programme. It will be logged in our Asset Management System for local repair works to be carried out.

Q44. Councillor Mannix Flynn

Can the manager have certain trees pruned and removed from these locations: Cathedral View and also Upper Clanbrassil Street on the left hand side (Clanbrassil Street East)? Also, would it be possible for the Parks Department to continue the planting and greening of the separator up Clanbrassil Street along the same lines as the successful planting of Nicholas Street?

Reply:

Parks Services shall arrange to undertake a survey of all roadside trees that are currently under charge in the Cathedral View / Upper Clanbrassil Street area with a view to including any works that are considered necessary in the 2018 Tree Pruning Programme.

It would be desirable to continue the planting in the median along Clanbrassil Street subject to the availability of funding. The proposal will be kept under active consideration.

Q45. Councillor Mannix Flynn

Can the manager install adequate lighting provision at the York Street apartment complex, Mercer Street area at the road junction? This area is extremely dark and dangerous for pedestrians and residents.

Reply:

We have investigated the existing lighting levels here, and whilst there is no requirement for additional lighting, we will consider upgrading the existing lighting on Mercer Street as part of future programme of improvements, subject to finances being available. The light on Pole no.5 Mercer Street Upper is currently not working due to an ESB service fault. A report has been sent to ESB Networks requesting them to have the cable repaired as soon as possible.

Q46. Councillor Mannix Flynn

Can the manager issue a full report as to the workability of the new technology litter bins that are in use in the South East Area? Many have complained that these bins are overflowing and generally unkempt. I spoke with some staff members who informed me that the technology was faulty and wasn't working. That some bins were reading empty when they were full etc. Also, that the actually policy in relation to this move be included in this report.

Reply:

A report on litter bins, technology and policy was recently completed for the Litter Sub Committee of the Environment SPC and this report is attached to this response.

The Solar Compactor Litter Bins in the South East Area have proven successful in terms of the performance of the technology, reduction in levels of servicing requirements and use of the litter bins by members of the public.

The capacity of these bins to overflow is reduced in comparison to traditional bins as the opening may not be used once the bin is full and it is also a closed unit. We are satisfied that the bins are not unkempt and are being serviced as required and maintained to a high standard

There is no issue with the bin technology identifying as full when the unit is not full and there is an on board suite of electronic diagnostics to indicate remotely if any part of the technology is faulty or has failed which is operating successfully with no concerns raised as to the capabilities of the units or the performance of the technology.

The rationale for carrying out a trial of this technology was to assess the effectiveness of the technology in different locations within the city with a variety of servicing needs.

The policy in respect of the continued use of this and other technologies is to provide for more efficient servicing of litter bins and provision of bins in the most appropriate locations with additional capacity provided where it most needed.

Litter Bins, Technology and Policy - Waste Management Division

Introduction

There is currently a stock of approximately 3500 standard litter bins in place in the Dublin City Administrative area. These comprise of 3 styles of litter bin:

- A type predominately situated in the city centre area (600)
- B type located in the suburban areas (2450)
- Cast Iron located in historic city areas. (450)



In addition Dublin City Council has recently installed 110 dog fouling specific litter bins in locations throughout the city identified in conjunction with the area departments at entrances to parks, green areas and areas of high footfall dog walking.

Dublin City Council currently has 48 solar compactor (Big Belly) bins in situ on a trial basis in 3 locations:

- Baggot Street and surrounds
 - Sandymount Promenade
 - Kilmainham at the historic jail.
- Dublin City Council has 9 Big Belly units located in Temple Bar that it owns.

Policy

It is the policy of Dublin City Council to maintain this stock of bins and to ensure that bins are located at the most effective locations to cater for the needs of the city population. The policy is to ensure that bins are located in close proximity to significant litter generators and in areas of high pedestrian footfall.

Significant litter generators and areas of high footfall include:

- Neighbourhood shops
- Schools / Educational Facilities
- Shopping centres
- Leisure areas
- Community centres / Facilities
- Major bus stops / Transport hubs
- Main thoroughfares / Arterial routes
- Car Parks

In order to ensure that bins are located in the most appropriate locations to cater for levels of demand and to ensure that bins are adequately serviced and maintained Dublin City Council is identifying ways of using technology to assist in managing this aspect of the service.

Bin Tagging

Dublin City Council is currently identifying each of its bins with a unique identifier number and QR code in order to map locations and maintain bin records. This system also allows for the public to scan the QR code and report via a 2 step process any issues that they might encounter.

This initiative allows DCC to better manage its stock of bins and coordinate maintenance and replacement of bin stock and identify through the mapping process areas where bins are not supplied in sufficient quantities or where there may be an oversupply of bins that could be relocated to areas of higher demand.



The QR code technology allows the public to report via a smart phone issues with bins. The report is directly relayed via the Customer Relations Management system to the operations teams allowing for a quick response to issues reported.

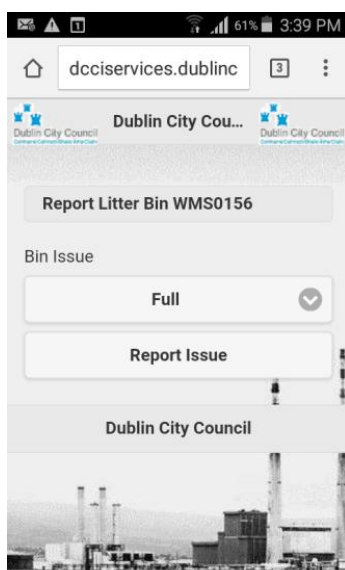

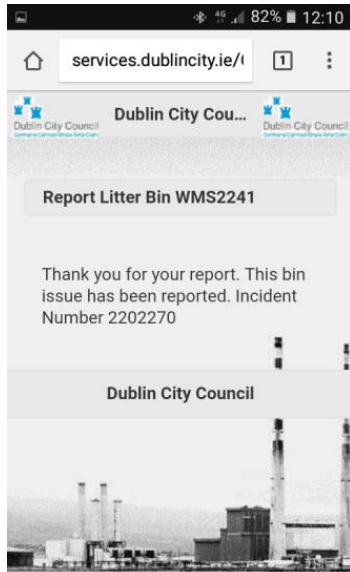

Bin Sensors

Complementary to the tagging and mapping process is the introduction of bin sensor technology. Currently in use on a trial basis, to assess the effectiveness of the technology, bin sensors that monitor the fill levels of bins and provide reports when bins require servicing is in place.



This technology allows DCC to identify high use locations and conversely locations that are low use or rarely used and may be potentially relocated to higher demand locations. It can also be used to map routes and assist in increasing street cleaning over bin emptying on traditional milk round style routes. The technology can be monitored via a web portal and alert systems set up at preset intervals to notify the relevant operations teams of bins that require servicing.

This technology has been used in 40 locations, 20 in Finglas Village and 20 in Drimmagh to date and results have included an overall increase in service efficiency by reducing the number of bin collections required over the period of the trial. The technology is relatively low cost and may be retro fitted to existing bins.

Solar Compactor Bins (Big Belly)



Dublin City Council has carried out a trial of Big Belly bins in a total of 48 locations and currently has 9 units installed in Temple Bar. These bins have the capacity to monitor fill levels and notify at set intervals and on an alert basis where bins require servicing. They also have the additional function of an on board compactor which gives the bin up to 6 times the capacity of a standard bin and consequently further reduces the frequency at which bins require servicing. The telemetry and compactor technology is solar powered. Similarly to the sensor technology alerts and route monitoring may be carried out via a web portal.

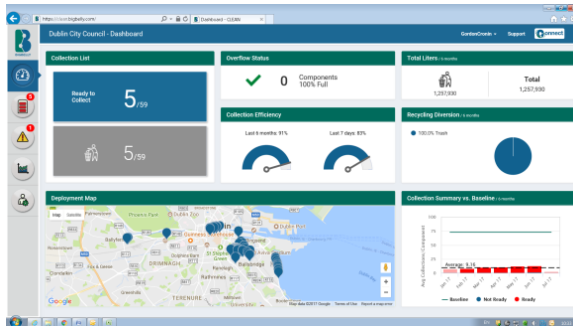

The screenshot displays the 'Dublin City Council - Fullness Information' page. It shows a 'Collection List' with 0 items and a table of bin details:

Bin ID	Description
CS-41	Meeting Room - Entrance to National Library of Ireland
89-20	August St. Corner - at Sals-Restaurant
86-21	Robert St. - at Bus Stop 761 - at Dunhills
81-38	at meeting beside the junction of Wellington Rd. & Parkville Rd.
87-10	Established/Operational Partnership - Charles Rd. - Ballybarnet

Below the table, it indicates 'Showing 1 of 1 Components'.

The trials have delivered impressive results and Dublin City Council has carried out a competitive tender process to procure this type of bin. It is expected that an initial purchase of this type of bin will be carried out in the near future.

This type of technology is costly and its use is considered to be most beneficial in areas of high demand such as neighbourhood shopping locations or amenity areas which may have seasonal peaks such as Sandymount and Clontarf promenade.

Q47. Councillor Mannix Flynn

Can the manager initiate a full assessment and examination for the placing of a pedestrian crossing from Bishop Street to Kevin Street? Many children and adults use this crossing and it is now extremely dangerous with the high volumes of traffic and also with the opening of the new Garda Station. The immediate area is a location for immense traffic flows and it is very confusing at the moment for motorists and pedestrians.

Reply:

A request for a pedestrian crossing at the above location is listed on the Traffic Advisory Group agenda for examination and report. The councillor will be informed of the recommendation in due course.

Q48. Councillor Mannix Flynn

Can the area manager issue a full report as to how much money is being spent on accommodating homeless individuals within the South East Area? This report to include all monies given to the various service providers, all fees paid to hoteliers, guest houses etc. Also to include all contractual arrangements and all properties that was acquired by the council for homeless services or housing services.

Reply:

The table below sets out the total spent from January 2017 to June 2017 in the South East Area on emergency accommodation services. The DRHE has not acquired properties in the South East Area for homeless services. Under the Capital Assistance Scheme, an application from an Approved Housing Body to acquire 18 units of social housing units in the South East area is currently awaiting approval from the Department of Housing, Planning & Local Government

South East Area	Jan to June 2017
Voluntary Bodies	€ 2,213,333
Private Emergency Accommodation	€ 433,616
Hotels	€ 2,521,914
	€ 5,168,863

Q49. Councillor Paddy McCartan

To ask the manager to indicate what progress has been made in relation to the breach of planning regulations at 31 Lower Leeson Street. The owner was to employ a conservation architect to ensure compliance. Have the necessary works been carried out?

Reply:

The owner has engaged a Conservation Architect and a planning application was to be made in respect of this property. To date the application has not been received. The Planning Enforcement Section is currently reviewing our position on this matter and the councillor will be updated shortly of our intended action.

Q50. Councillor Paddy McCartan

To ask the manager to ensure that graffiti is removed from a utility box on the traffic island at the junction of Nutley Lane and Stillorgan Road, Donnybrook.

Reply:

Graffiti at this location has been listed for removal.

Q51. Councillor Paddy McCartan

To ask the manager to deal with the following issue: When exiting Richelieu Park off Sydney Parade Avenue, Sandymount there is limited visibility to the left. This is due to cars parked tight to the corner on the avenue and since the introduction of parking meters in Richelieu Park. Yellow lines for a short section of Sydney Parade Avenue to enhance visibility on exiting the park could resolve the problem.

Reply:

There is a request for parking prohibitions at the above location listed on the Traffic Advisory Group Agenda for examination and report. The councillor will be informed of the recommendation in due course.

Q52. Councillor Paddy McCartan

To ask the manager for a report from Dublin Street Parking Services on clamping issues at Leahy's Terrace, Sandymount. Residents in the terrace have a parking permit but many have recently been clamped. Parking for residents in this area around the church is generally difficult and regularly impossible. This is primarily because of the daily high usage of the church and the proximity of both Star of the Sea and Saint Mathew's schools.

Local residents are concerned that if there is a parking control regime in the area that residents with parking permits are being targeted. Residents also feel that it is unacceptable and unfair to clamp a car with an up to date residents parking permit on its own street without firstly issuing a notice or warning.

Reply:

From the 1st August 2017 to date there have been eight vehicles clamped on Leahy's Terrace, for a range of offences, e.g. obstructing traffic, on a footway, pay & display area without valid permit, within 5 metres of junction / double yellow lines.

Of these just one was a Resident Permit holder who was clamped for being parked within 5 metres of a junction on a section of double yellow lines. All motorists, including those relying on a Resident Parking Permit when parking, are required to comply with parking controls and park legally at all times.

Q53. Councillor Paddy McCartan

To ask the manager to deal with the issues regarding the pond in Herbert Park. The pond has been more than partially refilled recently. This was done without removing all the rubbish first. There are branches, bricks and bottles, as well as other stinking detritus now submerged in the water. An opportunity for appropriate and judicious pruning of the vegetation on the two islands when the pond was empty all summer was lost. Many residents that frequent the park each day remain aghast and incredulous at the situation.

Reply:

Pruning work was undertaken on the trees, shrubs and vegetation on the two islands when the pond was empty. However as the islands are primarily a support for wildlife due care was taken not to disturb existing habitats and nesting sites which may have resulted in the mistaken conclusion that no work was undertaken.

Mud, debris and excess material was also removed from the base of the pond. However a pond of this age and history will have a natural ecosystem which has

built up over the years. This diversity of plant and animal material is to be found in the water and mud at the bottom of the pond. Therefore in keeping with best practice material has been retained to continue the pond ecosystem and diversity.

As refilling coincided with leaf fall a large amount of leaf litter was removed from the pond in the week prior to the pond being refilled. However as there were still a large number of leaves yet to fall, particularly from the large Chestnut trees planted close to the pond and with the impact of storm Ophelia it was inevitable that some additional debris, mostly leaves and broken branches etc. did fall into the pond during the refilling process. This material will be removed as part of our ongoing pond maintenance over the autumn and winter months.

Filling of the pond has now been completed and will be topped up using a sustainable water source from the R. Dodder with overflow water being returned to the river.

Q54. Councillor Paddy McCartan

To ask the manager to deal with the issue of the pavements on Seafort Avenue, Sandymount. The street has a number of elderly residents including a stroke victim with walking difficulties. The uneven surface is dangerous for them and other residents. Many wheelchair users in the nearby Rehab on Strand road use Seafort Avenue regularly and the pavement is making their commute difficult and potentially dangerous.

Reply:

The footpaths at this location are logged in our Asset Management System for local repair works to be carried out.

Q55. Councillor Paddy McCartan

To ask the manager to deal with the issue of the new traffic layout at the Herbert Park / Morehampton Road intersection. Residents have noticed a huge back up of traffic on Herbert Park backing onto Pembroke Park. The main reason for this delay is that only one car is able to go straight through / left or right on to Morehampton Road at peak times. The traffic lights are red for three minutes and the main issue here is traffic turning right from Herbert Park. A possible restriction on the right turn at the junction between 4pm and 7pm might alleviate the build up. There are also implications for traffic coming down Marlborough Road and turning right into Morehampton Road at peak times. Finally, is it the intention to retain the pedestrian crossing at Donnybrook fair?

Reply:

No changes have recently been made to the signal timings at the junction on Herbert Park / Morehampton Road. The reported delays could be as a result of the construction of the full wrap around pedestrian crossing that is currently being carried out at this site. The Traffic Advisory Group is expecting that the job will be finished by the 2nd week of December 2017.

The pedestrian crossing at Donnybrook Fair will be retained.

The area engineer and the traffic officer (ITS) will review the traffic signal timings when the works are completed

Q56. Councillor Frank Kennedy

In light of the wholly unsatisfactory state of traffic arrangements and flow on Belmont Avenue, Dublin 4, as well as the severe risk of injury to pedestrians and cyclists

arising from the status quo, to ask the manager to conduct a full survey of this road and to implement a solution as a matter of urgency.

Reply:

The area engineer will assess Belmont Avenue on Tuesday 21st of November at school drop off time 8:00am to 9:00 am, and recommendations will be made in order to protect pedestrians and cyclists.

Q57. Councillor Frank Kennedy

To ask the manager to renew / repaint the “No Cycling” signs on the paths just inside the gates of Herbert Park.

Reply:

The ‘no cycling’ signs on the park paths will be repainted over the coming weeks.

Q58. Councillor Frank Kennedy

To ask the manager to renew / repaint the control of dogs signs inside the gates of Herbert Park.

Reply:

The signs inside the gates and on the paths at Herbert Park were repainted last week

Q59. Councillor Frank Kennedy

Ramleh Villas is a row of 20 semi-detached houses on Milltown Road. The only Ramleh Villas name sign is on the house wall of no. 20 which is beside the shops. The resident of *details supplied is a senior citizen and her home is the last house before the turn into Ramleh Park. She needs helpers but said several of them have trouble locating her house as it is so badly signposted. To ask the manager to put a Ramleh Villas sign on her house (which would be well visible as there are no trees nearby) or on her gate, which she would happily consent to?

Reply:

This will be included in our next nameplate erection contract.

Q60. Councillor Frank Kennedy

To ask the manager to conduct a traffic survey in consultation with local residents on Avenue Road, Portobello and to consider the installation of at certain suitable locations of yellow lines, if considered to be appropriate.

Reply:

The Area Traffic Engineer carried out a site inspection on the 7th November – please see photos below;

Date of the site inspection 7-11-17 Time: 9.00am
Current situation at Avenue Road Portobello:

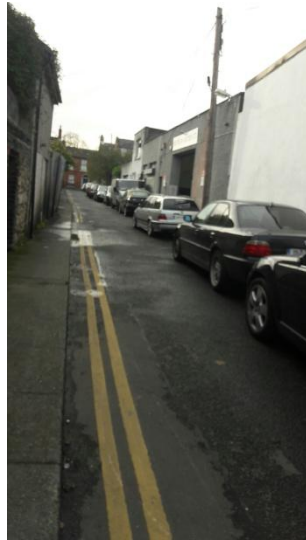

Cars parking on one side of the road

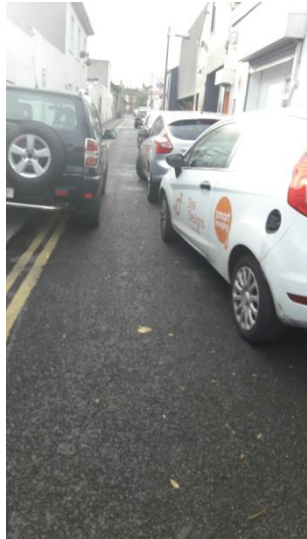

The engineer noted that vehicles cannot pass through due to the insufficient width of the road. Standards require a minimum carriageway width of 4.6m in order to

accommodate single sided parking while maintaining traffic flow. The width of the carriageway at Avenue Road is 3.8m. It is therefore recommended that double yellow lines be installed on both side of the road, to improve the traffic flow along Avenue Road and to prioritise access of emergency vehicles and fire brigade. The relevant statutory order will therefore be prepared.

Q61. Councillor Frank Kennedy

To ask the manager for a report on the Office of Public Works (OPW) plan to build a science museum in the Iveagh Gardens in circumstances where the Iveagh Gardens are a protected structure and were given to the state under the condition that they remain intact as a lung for the city, to include, in particular, consideration of the viability of the museum itself.

Reply:

The councillor's question has been referred to the Office of Public Works.

Dublin City Council granted permission to the Commissioners of Public Works for a development which includes the following: the refurbishment and restoration of the existing north and part of the east wing of the existing National Concert Hall (NCH) and the Real Tennis building; the construction of a new four storey over basement extension with a planetarium dome to the west of the north wing at the boundary of the Iveagh Gardens and the change of use from the former University College Dublin (UCD) School of Civil Engineering to the National Children's Science Centre. The planning reference is 2362/16. The decision was the subject of a third party appeal by the Irish Real Tennis Association. An Bord Pleanála granted permission for the development on 14th September 2016. As part of the permitted development a section of the boundary wall along the Iveagh Gardens is to be demolished, allowing for a new access ramp and steps into the Iveagh Gardens and connecting the Iveagh Gardens to the new 4 storey building and the National Children's Science Centre. Both the NCH and the Iveagh Gardens are under the control of the Office of Public Works

An Bord Pleanála considered the issue of the demolition of a section of the boundary wall between the NCH / UCD site. It observed that the Iveagh Gardens were the original pleasure grounds of the 1865 Dublin Exhibition, whose Great Hall is now the auditorium of the NCH. It noted that the buildings and gardens were integrated for the 1865 Exhibition and were only separated in 1882 following the acquisition of the buildings by the government to house the university and the gardens by Edward Cecil Guinness.

It concluded that the demolition of a section of the boundary wall between the NCH / UCD site and the Iveagh Gardens and the creation of a plaza to connect the two sites was acceptable, having regard to the historical context outlined above which describes the two sites as originally being interconnected.

It is also important to note that the following objectives in the Development Plan are of relevance:

"15.1.1.21 - SDRA 18 National Concert Hall Quarter

- *Consolidate and further enhance the cultural significance of the area, including facilitating significant improvements to the National Concert Hall, **the development of the exploration station by the Irish Children's Museum and increased accessibility and linkages with the Iveagh Gardens**, in order to establish the area as a key cultural attraction in the city centre.*

*To create significant improvements to the public realm throughout the character area through economic development and investment, creating lively streets and passive surveillance, contributing to a vibrant and attractive urban area. **Development in the National Concert Hall quarter should create pedestrian linkages through the Iveagh Gardens to the National Concert Hall, and the development of a high quality public space on Hatch Street Upper to signal a new public entrance to Iveagh Gardens from Hatch Street.***

Q62. Councillor Frank Kennedy

To ask the manager to provide a full report on the following complaint *details supplied.

Reply:

This is currently logged in our Asset Management System for action when a crew becomes available.

Q63. Councillor Frank Kennedy

To ask the manager for a report on the position as it stands in respect of applications for the affordable housing scheme which will arise on foot of the residential development at the Poolbeg West Strategic Development Zone (SDZ).

Reply:

Dublin City Council has requested the Department of Housing, Planning and Local Government, to bring forward legislation for the provision of affordable housing. The Housing & Community Department propose to bring an Affordable Housing Scheme to the city council for approval as soon as the legislation is in place.

Dublin City Council, at its meeting on 2nd October 2017, decided by resolution to make the Poolbeg West Planning Scheme. Text contained in Section 3.5 of the Scheme states that:

‘Of the 3,500 new homes permissible on the site under this Planning Scheme, 900 will be delivered as either social and/or affordable units including units for senior citizens. A minimum of 350 (10%) will be delivered as social housing in accordance with the provisions of Part V of the Planning and Development Act 2000, (as amended). In addition, given public investment in enabling infrastructure for the area and in order to ensure a proper and sustainable tenure mix, a commercial agreement with confirmed funding will be entered into, prior to commencement of development, between Dublin City Council, the Department of Housing, Planning, Community and Local Government and the owners/developers of the residential element of the overall SDZ area which will ensure the delivery of the balance of the social/affordable homes’

Following the approval of the Planning Scheme by the elected members there was a four week appeal period during which any person(s) who made submissions or observations in relation to the Draft Planning Scheme, could appeal the decision of the planning authority to An Bord Pleanála. A number of appeals have now been lodged with An Bord Pleanála.

Following the consideration of the appeals An Bord Pleanála may approve, with or without any modifications, or refuse to approve the making of the planning scheme. An Bord Pleanála has stated that the case is due to be decided by 21 February 2018. It should be noted that the decision date is subject to change.

Following the decision of An Bord Pleanála, should the scheme be approved (subject to possible modifications) planning applications will be assessed in accordance with

the planning scheme as approved by the board. In relation to the position as it stands, i.e., for planning applications submitted in advance of the board's decision, these will be assessed with regard to the existing Part V requirements i.e. for 10% social housing.

Q64. Councillor Frank Kennedy

To ask the manager to address the two issues raised in the correspondence below with regard to Ringsend Park:

"I am writing to you on two matters that are causing anxiety among my family, neighbours and the old aged pensioners that are living in Ringsend Park...

*Firstly, I am writing to you to highlight my concern relating to a tree that is approximately 90-100 foot high and growing. This tree is located no more than 3 metres at the rear of *details supplied 1. I am also contacting you on behalf of my neighbours *details supplied 2. Collectively, we have sought advice and it has been directed that we bring your attention to this particular tree because of its close proximity to our houses and the fact that its branches overhang our properties by 8 - 10 feet. Over the last year and during the recent high winds there has been a noticeable increase in movement and creaking coming from the branches. We are extremely worried that if this tree or any part of this tree comes down at any time it could cause serious injury or even death, not to mention a considerable amount of damage and destruction to any of the above properties.*

*Recently, hurricane Ophelia brought down a number of trees in the park, these trees would have been considered healthy and not in danger of falling over whilst sustaining high winds, so it is not beyond the realm of possibility that this could happen to the tree at the back of our properties. In addition to this, over the years a number of trees behind the tennis courts that are smaller and further away from properties have been removed at the request of residents. In order to avoid a tragedy that Dublin City Council would be held accountable for, the residents of *details supplied 1 and 2 would ask that you give this matter your utmost immediate attention and remove any trees that are overhanging the above properties at your earliest convenience for the safety of our properties and the people that reside in them.*

Secondly, there has been a noticeable reduction of unsociable behaviour in Ringsend Park in the recent year, and this has been due to active response from the Guards and positive interaction between the neighbours and Superintendent Delmar. However, recently there has been a rise on the front of anti-social behaviour; in particular lighting fires to trees and leaves. I would be very grateful if you could reduce this threat by regularly removing the dead leaves that are piling up due to the dense amount of trees directly behind our houses."

Reply:

The tree in question is a mature Lime tree (*Tilia* sps.) and considered to be in good condition, based on a ground level inspection.

There was no evidence of damaged or broken branches in the crown of the tree resulting from recent storms. This may be due to the good condition of the tree and also to the relatively sheltered location in which it is growing.

The movement of the tree in high winds is a natural protective measure of trees which helps them to strengthen the tree crown and trunk over the life span of the tree. It was observed that there are a number of 'crossing branches' in the tree trunks

which would have caused a creaking noise as the tree moved in the wind. However, there was no evidence of damage to these branches.

Considering the age, species and location of the tree it is recommended that the height of the tree is reduced by 15 - 20% and some of the 'crossing branches' be removed or thinned allowing for ease of air flow within the tree crown. The works will also provide an opportunity for a more detailed inspection of the tree crown to take place by an experienced arborist and we can also deal with any dangerous overhanging.

This work will be added to our 2018 Tree Works Programme. These works are undertaken on a priority basis over the year, subject to available funding.

Leaf litter in the park is currently being collected and this process will continue over the coming weeks until it is all removed or composted in the park.

Q65. Councillor Frank Kennedy

To ask the manager to consider the implementation on a trial basis of 3D zebra crosswalks to slow down speeding cars as has been done successfully in Iceland. An example of the proposal is visible at this link:

<https://www.boredpanda.com/3d-pedestrian-crossing-island/>

Reply:

Dublin City Council does not recommend zebra crossings as they are generally not effective at changing driver behaviour and may provide a false sense of safety to pedestrians. A pedestrian does not have the right-of-way until they actually step onto a zebra crossing.

The Area Traffic Engineer has confirmed that the possible use of 3D Zebra Crossings would need to be validated by the Department of Transport, Tourism and Sport.

Q66. Councillor Frank Kennedy

To ask the manager to ensure that a response is sent to the below exchange of email correspondence (details supplied).

Reply:

The request for a disabled parking bay at the above address will be referred to the Traffic Advisory Group for examination and report on the basis of the confirmation from the resident, as set out in the email exchange above, that there is no off-street parking at the address. It is expected that a report will be submitted to the Traffic Advisory Group at its meeting of 28th November 2017.

Q67. Councillor Claire Byrne

To ask the area manager what is the situation with all the vacant properties on Chatham Street and what plans are in place to address these vacant buildings. This is a core street off one of the busiest streets in the city and it is criminal to see it virtually vacant.

Reply:

A visual inspection was undertaken of this street on 2nd November 2017. It was noted at that time that there were possibly two vacant commercial units on the street, and possibly one unit that had vacancy at upper floor levels. There was also a section of the street, known as Chatham Court, which appears to be under construction (under reg. ref. 4436/16). At the time of the site visit the remaining units on this street were actively in use.

Q68. Councillor Claire Byrne

To ask the area manager to please increase the frequency of street cleaning on Synge Street, Grantham Street, and Grantham Place, Portobello as a matter of urgency as these streets are experiencing an increase in litter due to night time activity on neighbouring Camden Street.

Reply:

Waste Management Services have the above mentioned streets cleaned on a weekly basis. However, we have this area monitored on a regular basis and have extra cleaning carried out there when necessary to do so.

Q69. Councillor Claire Byrne

To ask the area manager how many 'Environmental Area Signs' were originally put up on the Portobello area, how many remain, is Portobello still designated as such an area and if so could she please reinstate those signs that have been removed.

Reply:

Clarification has been sought from the councillor. The matter will be further investigated on receipt of same.

Q70. Councillor Claire Byrne

To ask the area manager if she could please prune the trees on McMahon Street, Portobello as a matter of urgency.

Reply:

Two of the four cherry trees on McMahon Street require minor pruning. The work is not considered urgent and accordingly has been listed for pruning over the coming weeks.

Q71. Councillor Claire Byrne

To ask the area manager if she can please provide further street lighting on Lombard Street West, Desmond Street and Emorville Avenue and to ask that these streets be prioritised for early 2018.

Reply:

There is no Public Lighting improvement Programme intended for the above at the moment. However, we will investigate the existing lighting and any necessary improvements will be added to a list for inclusion in a future public lighting programme of improvements, subject to finances being made available. We will continue to carry out routine maintenance works on the existing lights and will replace existing lamps as required.

Q72. Councillor Claire Byrne

To ask the area manager which streets in the South East Area have been identified for the roll out of the public lighting LED replacement scheme, if she can please provide a list of streets and a timeline for the roll out on these streets.

Reply:

We are currently replacing all SOX (yellow) lanterns in the South East Area. All SON (golden white) lanterns and heritage columns are not included in this replacement programme. Public Lighting engineers aim to complete their individual LED replacement targets by the end of the year. We will then review any outstanding streets and a possible timeline for the roll out on these streets.

Q73. Councillor Claire Byrne

To ask the area manager can she please investigate the following concerns made by neighbouring residents of details supplied:

Reply:

The Air Quality Monitoring and Noise Control Unit will carry out an investigation of this matter under the Air Pollution Act 1987 in terms of the potential nuisance factor as a result of an emission. To that end, it is requested that the contact details for the complainants be forwarded to the unit so that the investigation can commence.

The gas installation is the responsibility of Bord Gáis (Gas Networks Ireland) to ensure the installation is compliant with the appropriate standards and they are best placed to resolve this matter.

Traffic Advisory Group Minutes 28th November 2017												
Item	TAMS Ref	Sharepoint Ref	request	Road	Post Code	topic	request_description	Request by	Date Rec'd	Result	TAG Comments	sec
1	7000092		Engineer Query	MERRION STREET LOWER (SE)	Dublin 2	TAG General Engineer Query	Set down areas outside the Davenport Hotel on Merrion Street Lower and outside the Alexander Hotel on Fenian Street	Member of the Public	31/10/2017 10:48	Not Recommended	It is not recommended to rescind the existing taxi ranks as there are very high demands to provide place for taxis at both of these locations. Furthermore, the engineer is looking to increase the taxi rank spaces in the area. It is not recommended to make any change in parking at: Merrion Street Lower outside the Davenport front entrance. Fenian Street to the side of the Davenport.	0
2	7000239		Turning Restrictions	DAWSON STREET (SE)	Dublin 2	Right Turn Only	additional various measures for LUAS coming on-line on Daswon Street	Internal	07/11/2017 15:30	Recommended	1) Right turn arrow on Dawson Street at Molesworth Street junction. 2) Rescind straight ahead arrow at Marco Pierre White Restaurant on the west side of 51 Dawson Street.3) Rescind straight ahead arrows on Dawson Street between Duke Street amd Nassau Street. 4) Diagonal hatched marking on west side of Dawson Street from the corner of Duke Street extending northwards for 15m. 5) Left turn arrow on Joshua Lane onto Dawson Street. 6) Straight ahead arrow on Dawson Street at the junction of Joshua Lane .	0

3	7000297		Double Yellow Lines	AVENUE ROAD (SE)	Dublin 8	Double Yellow Lines	Double Yellow Lines on Avenue Road.	Councillor	09/11/2017 15:26	Recommended	Due to the narrowness of the carriageway it is recommended to introduce double yellow lines on both sides of the road, to improve the traffic flow and prioritise access of emergency vehicles and fire brigade. Recommended STATS as follows: 1) From the junction of Bloomfield Avenue with Avenue Road, extending 12m east, install a double yellow line extending 55m eastward on the east side of Avenue Road. 2) From the junction of Bloomfield Avenue with Avenue Road, extending 12m east, install a double yellow line extending 60m eastward on the west side of Avenue Road. 3) From the junction of St Kevin's Road with Avenue Road, on the west side of Avenue Road install 140m of double yellow line extending northwards.	0
4	7000441		Yellow Box	TERENURE ROAD EAST (SE)	Dublin 6	Yellow Box (Extend)	outside Aldi	Internal	16/11/2017 16:52	Recommended	Extend the existing yellow box at the entrance to the Aldi store at Terenure Cross across the inbound and outbound carriageways as far as the pedestrian crossing (located east of the entrance).	0
5	7000494		Disabled Parking Bay	SEAFORT AVENUE (SE)	Dublin 4	Disab Park Bay Residential	Outside No. 14	Councillor	21/11/2017 12:02	Recommended	Disabled parking bay recommended from the point in line with the entrance to no. 14 Seafort Avenue extending northeast for a distance of 6 metres.	0

6	7000590		Double Yellow Lines	WILTON PLACE (SE)	Dublin 2	Double Yellow Lines	removal of p&d bays and replace with dyls on west side of Wilton Place	Member of the Public	24/11/2017 15:19	Recommended	On the northwestern section of Wilton Place, rescind pay and display and permit parking from IDA carpark ramp access extending southwards for 25 metres. Install double yellow lines from the IDA carpark ramp access extending southwards for 20 metres. On Wilton Place (park side), rescind pay and display and permit parking from the point in line with the western pedestrian entrance to Court Apartments extending west and south west for a distance of 30 metres. Install double yellow lines on Wilton Place (park side) from the point in line with the western pedestrian entrance to Court Apartments extending west and south west for a distance of 30 metres.	0
7	7000591		Parking Bays	WILTON PLACE (SE)	Dublin 2	Electric Car Bay	relocate electric vehicle bays on the north side of Wilton Place.	Member of the Public	24/11/2017 15:20	Recommended	Rescind Pay and Display and Permit Parking on the northern side of Wilton Place from the western pedestrian entrance to Court Apartments extending southeast for 10 metres. Install electric vehicle only charging bays on the northern side of Wilton Place from the western pedestrian entrance to Court Apartments southeast for 10 metres. Install double yellow lines from the west side of the western pedestrian entrance to Court Apartments extending northwest alongside the footpath buildout for 7.5 metres..	0

8	90045199	SP_18656	Double Yellow Lines	SAINT ENDA'S ROAD (SE)	Dublin 6	Double Yellow Lines	on the laneway to the east of St. Enda's Road, rear of Nos. 65-68, Brighton Road.	Councillor	12/06/2015 15:17	Recommended	<p>It is recommended to install double yellow (DYL) lines on both side of the lane way in order to facilitate access for the emergency vehicles. During a site inspection made on the 23-11-17, it was found that lane way located on the rear of 65 to 67 Brighton Road has a carriageway width of 3.8m.</p> <p>The current Dublin City Council requirements for single sided parking is 4.6m, as this is not achievable on the lane way DYL are recommended. Recommended STAT as follows:</p> <ul style="list-style-type: none"> •Install DYL on both sides at the laneway that is located on the rear of 65, 66 and 67 of Brighton Road, from the common boundary of the rear of 64/65 Brighton Road install 28m of DYL extending northwards. From this point install 3.8m of DYL extending westwards , then install 28m of DYL southwards at the side of 25 St. Enda's Road. 	0
9	90046548	SP_34243	Parking Bays	EMOR STREET (SE)	Dublin 8	P&D/Permit Park (Change Hours)	for extension of the operational hours.	Member of the Public	11/10/2016 16:23	Recommended	Accepted at survey, Change hours to Mon-Sun 07.00-24.00. 67 on register of electors, 50 votes returned, 28 for, 14 against, 8 spoilt (5 not on register, 3 late). The pro-rata vote was 28 for and 14 against.	0
10	90046591	SP_34470	Parking Bays	HOLLYBANK AVENUE LOWER (SE)	Dublin 6	P&D/Permit Park (Change Hours)	for extension of operational hours on Hollybank Avenue Lower & Upper.	Member of the Public	19/10/2016 10:31	Recommended	Accepted at ballot, Mon-Sun 07.00-24.00. 176 on reg. 85 votes returned, 56 for, 24 against, 5 late. The pro-rata vote was 52 for, 24 against.	0
11	90046944	SP_35794	Disabled Parking Bay	BELGRAVE ROAD (SE)	Dublin 6	Disab Park Bay Residential	outside No.11. Pay and Display and Permit Parking will have to be rescinded.	Member of the Public	10/01/2017 17:05	Recommended	<p>Rescind Pay and Display and Permit Parking from the point in line with the common boundary 11/12 Belgrave Road extending eastwards for 6 metres.</p> <p>Install Disabled Parking Bay from the point in line with the common boundary 11/12 Belgrave Road extending eastwards for 6 metres.</p>	0
12	90047042	SP_35893	School	HANOVER STREET EAST (SE)	Dublin 2	School Warden	School Warden	Councillor	16/01/2017 12:43	Not Recommended	The location is not suitable for a school warden in terms of lack of access to storage for sign/uniform.	0

13	90048809	SP_37678	Traffic Calming	TERENURE ROAD EAST (SE)	Dublin 6	Traffic Calming	Request for ramps and/or traffic lights on the road.	Member of the Public	26/04/2017 10:51	Not Recommended	• In references of introduction of traffic calming: Terenure Road East is a major strategic arterial route linking Rathgar Road and Terenure Road. It also is a bus route and an emergency services route with high traffic volumes. There is a pedestrian crossing on this section of road which acts as a traffic calming measure. For these reasons, the provision of extra traffic calming measures is not recommended at this time.	0
14	90049786	SP_38668	Disabled Parking Bay	OAKLANDS PARK (SE)	Dublin 4	Disab Park Bay Residential	Outside No. 20. Pay and display and permit parking will have to be rescinded.	Member of the Public	13/06/2017 12:06	Recommended	Rescind pay and display and permit parking from in line with the common boundary between No.'s 18/20 Oaklands Park extending southwards for 6 metres. Disabled Parking Bay recommended from in line with the common boundary between No.'s 18/20 Oaklands Park extending southwards for 6 metres.	0
15	90049928	SP_38812	Disabled Parking Bay	WINDSOR ROAD (SE)	Dublin 6	Disab Park Bay Residential	Outside No. 40. Pay and Display and Permit Parking will have to be rescinded.	Member of the Public	20/06/2017 13:14	Recommended	Rescind pay and display and permit parking from in line with the eastern boundary of no. 40 Windsor Road extending westwards for 6 metres. Recommend Disabled Parking Bay from in line with the eastern boundary of no. 40 Windsor Road extending westwards for 6 metres.	0
16	90050216	SP_39110	Parking Bays	POWER'S COURT (SE)	Dublin 2	P&D/Permit Park (Change Hours)	for extension of the operational hours.	Member of the Public	11/07/2017 10:01	Awaiting Survey	Recommend extension of operation hours subject to ballot of residents.	0
17	90050333	SP_39228	Pedestrian Facilites	TERENURE ROAD EAST (SE)	Dublin 6	Pedestrian Crossing	just east of junction with Terenure Road North	Member of the Public	18/07/2017 15:57	Recommended	Recommended to install pedestrian crossing at Terenure Road North with Terenure Road East. This project is to be listed on the Programme of Works for 2018.	0
18	90051263	SP_40165	School	TERENURE ROAD EAST (SE)	Dublin 6	School Warden	Between Aldi entrance and Greenmount Road	Councillor	08/09/2017 12:16	Not Recommended	There is already a pedestian crossing outside the school, we are reluctant to placing school wardens on pedestrian crossings as it is doubling up on a resource that is already in place.	0
19	90051264	SP_40166	School	TERENURE ROAD EAST (SE)	Dublin 6	School Ahead Sign	Between Aldi entrance and Greenmount Road	Councillor	08/09/2017 12:21	Recommended		0

20	90051275	SP_40177	Traffic Calming	TERENURE ROAD EAST (SE)	Dublin 6	Traffic Calming	at Saint Joseph's Boys National School	Member of the Public	08/09/2017 13:31	Not Recommended	• In references of introduction of traffic calming: Terenure Road East is a major strategic arterial route linking Rathgar Road and Terenure Road. It also is a bus route and an emergency services route with high traffic volumes. There is a pedestrian crossing on this section of road which acts as a traffic calming measure. For these reasons, the provision of extra traffic calming measures is not recommended at this time	0
21	90051358	SP_40262	Double Yellow Lines	WILFIELD ROAD (SE)	Dublin 4	Double Yellow Lines	between No. 41 - No. 43.	Member of the Public	13/09/2017 11:41	Pending	Double yellow lines recommended between No.'s 41/43 Wilfield Road from southern side of driveway at No. 41 extending south to northern side of driveway at No. 43.	0
22	90051486	SP_40395	School	TERENURE ROAD EAST (SE)	Dublin 6	School Warden	safety concerns - request to carry out traffic surveys, risk assessment at St Joseph's National School	Member of the Public	20/09/2017 16:02	Recommended	School Warden recommended as the count met the criteria.	0

23	90051616	SP_40526	Parking Bays	LENNOX STREET (SE)	Dublin 8	P&D/Permit Parking (Rescind)	Pay and display parking bay closest to junction with Richmond Street	Member of the Public	29/09/2017 00:00	Recommended	<p>It is recommended to alter the layout of the existing Pay and Display bays in order to facilitate the bus priority as a requested by the NTA.</p> <p>Recommended Stat:</p> <ul style="list-style-type: none"> • Rescind Pay and Display, from the lamp stand number 2 extending 20m eastwards, and from the lamp stand number 2 extending westwards 6m. • Rescind Pay and Display from the corner of the house number 1 (outside of the Bretzel Bakery) at Lennox Street extending 17m eastwards. • It is recommended to introduce parking for bicycles in the new build out at Lennox Street. <p>Furthermore, it is recommended to install No Right Turn (RUS 012) on the west side Richmond Row at the lamp stand number 1. A supplementary plate it is recommended with a time table Monday to Friday 7.00 to 10.00 (P051). (The traffic officer may change the specific location on the site) This job will be carried out by the Bus Priority.</p>	0
24	90051875	SP_40789	Parking Bays	BAGGOT LANE (SE)	Dublin 4	P&D/Permit Parking (Rescind)	Rescindment of parking bay between No. 106 and 108 / replace by DYL's.	Member of the Public	11/10/2017 00:00	Recommended	Rescind Pay and Display and Permit Parking from pedestrian entrance to 106 Baggot Lane extending east to pedestrian entrance to 108 Baggot Lane. Install double yellow lines from in line with pedestrian entrance to 106 Baggot Lane extending east to pedestrian entrance to 108 Baggot Lane.	0

**To the Chairman and Members of the
South East Area Committee**

With reference to the proposed disposal of the Council's fee simple interest in plot of land at the rear of 1 Eglinton Road, Donnybrook, Dublin 4.

Under Indenture of Lease dated 6th January 1994 Dublin City Council let a plot of land at the rear of No. 1 Eglinton Road, Donnybrook, Dublin 4 which said plot is more particularly outlined red and coloured pink on Map Index No. 7780-11 to J. Peter Neary for a term of 35 years from 1st May 1993 subject to an initial annual rent of €253.95 (£200) for use as a garden in relation to the premises at 1 Eglinton Road.

By way of Deed of Variation dated 28th September 1998 the lease was varied insofar as it related to the rent review provisions such that thereafter the rent was to be reviewed in line with any increase in the Consumer Price Index. The current passing rent is €413.62 with effect from 1st May 2013.

The current lessee is Martaban DAC with a registered office at 25-28 North Wall Quay, Dublin 1, D01-H104.

Martaban DAC has applied to Dublin City Council to acquire the council's fee simple interest therein. The Chief Valuer's Office reports that terms and conditions have been agreed which he considers fair and reasonable and accordingly it is proposed to dispose of the property as follows:

1. The disposal shall be in the sum of €375,000 (Three Hundred and Seventy Five thousand euro) plus VAT if applicable.
2. The subject plot has an area of 142 sq.m or thereabouts as outlined in red on Map Index 7780-11.
3. The council shall transfer the unencumbered freehold title or equivalent in the subject plot.
4. The applicant shall be responsible for the council's valuer's fees of €2,500 plus VAT and legal fees plus VAT in this matter.

Paul Clegg.
Executive Manager.

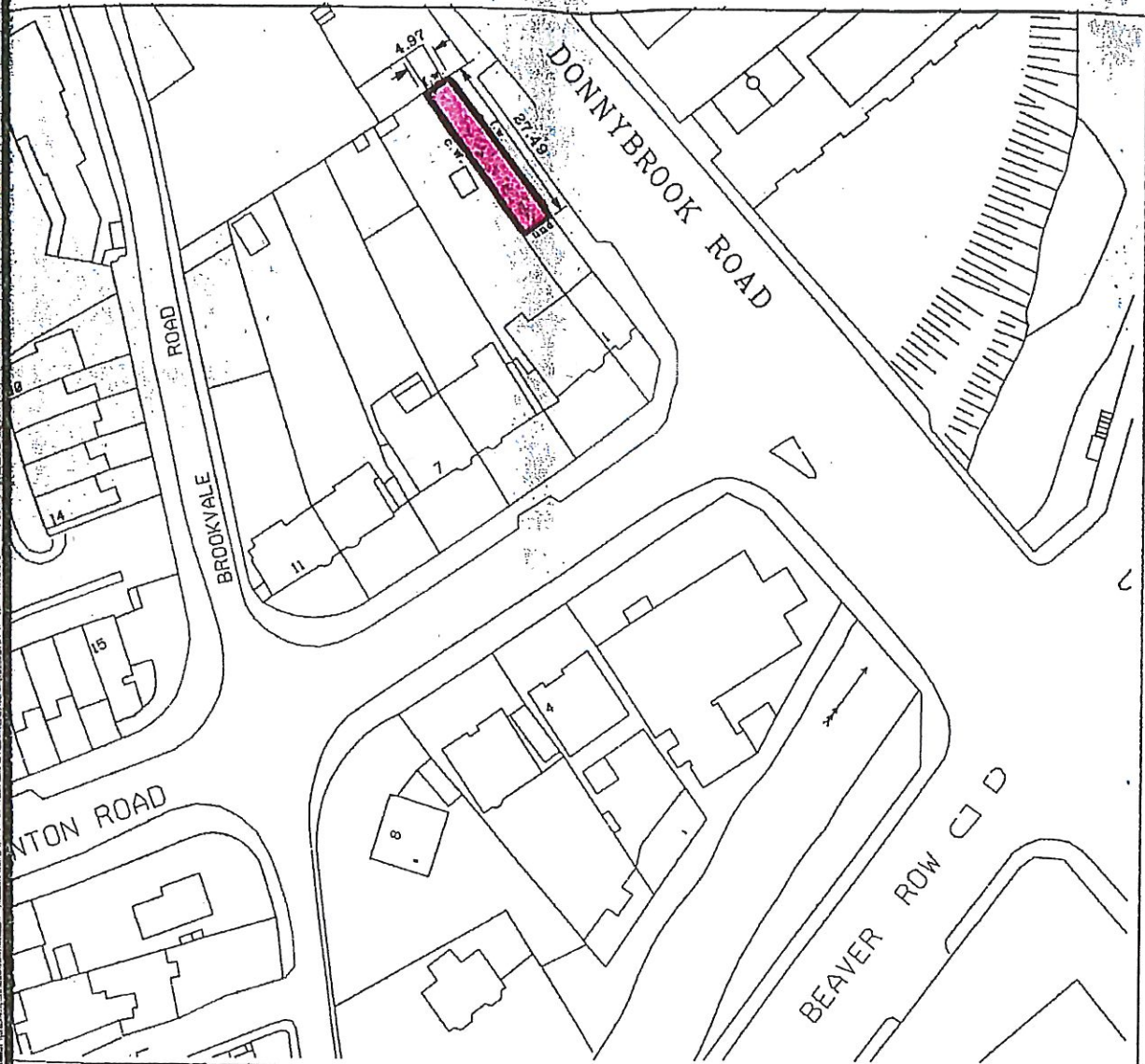



No. 1 Eglinton Road – Plot at Rear.

Corporation to J. Peter Neary.

35 Year Lease

AREA : 142 sq.m.

 <p>BÁRDAS ÁTHA CLIATH ENGINEERING DEPARTMENT • DESIGN AND DEVELOPMENT SURVEY AND MAPPING SECTION</p>		SCALE	
		1:1000	
		CODE	C 3
 <p>ENWICK CHIEF ENGINEER ENGINEERING SERVICES</p>	SURVEY / MADE BY	REVISIONS :	BY DATE
	J.F.M.		
	DATE		
	01/06/1993		
			INDEX NO.
			7780-11

3328-03 ; 3328-08

To the Chairperson and Members of the
South East Area Committee

Community Development Section Report

Please find below a list of forthcoming Christmas events organised or supported by the Community Development Team of the South East Area Office/Dublin City Council:

Wednesday, 6th December at 2pm - Maxwell Court Christmas Party at Maxwell Court, Rathmines. Christmas get-together for older people with chat and refreshments.

Wednesday, 6th December at 2.30pm - Una Celebración de Navidad at Charlemont Court, Charlemont Mall. Christmas get-together for the Spanish language walking group with chat and refreshments.

Thursday, 7th December at 7pm - A Rathgar Village Christmas organised by Rathgar Traders and local churches, featuring a local choir and an appearance from Santa on his horse drawn sleigh.

Thursday, 7th December at 8pm - Rathgar Ladies' Club Christmas Party at St. Patrick's Hall, Church of the Three Patrons in Rathgar, with a live performance by singer, Angel Brennan.

Friday, 8th December at 2pm – Pearse Street Christmas Sing-along at St. Andrew's Resource Day Care Centre. Festive event for older people with refreshments and live music from the band, Pastimes. Event organised by St. Andrew's Resource Day Care Centre.

Friday, 8th December at 8pm – Beech Hill Court Christmas Party at Beech Hill Court Community Centre. Christmas meal and live entertainment for local older people. Invitation only.

Saturday, 9th December at from 10-4pm – Swan's Santa Christmas at Swan Leisure, Rathmines. Festive charity event organised by Swan Leisure with proceeds going to Rathmines Women's' Refuge and Inner City Helping Homeless. Special appearance by Santa Claus from 10-12pm.

Saturday, 9th December at 1pm – AMBI Christmas Party at St. Joseph's Parish Hall, Terenure. Family event organised by the Association of Brazilian Mothers in Ireland with music, festive treats and an appearance by Santa on his horse drawn sleigh.

Sunday, 10th December at 2pm - Havelock Square Christmas Party at Havelock Square in Sandymount. Festive event arranged by local residents with face painting and traditional Christmas fare.

Tuesday, 12th December at 12 noon - Verschoyle Court Social History Project Launch. Launch of CD & booklet which involved participants from the complex.

Tuesday, 12th December at 2pm - Verschoyle Court Christmas Party. An afternoon of song and dance for older people with live music from the duo, Pastimes.

Wednesday, 13th December at 12.30pm – Evergreen Club Christmas Dinner at the Evergreen Centre, Terenure. Festive meal for the centre's community groups with live musical performance too. Invitation only.

Thursday, 14th December at 10am – Terenure Parent & Toddler Group Christmas Party at the Evergreen Centre. Fun, games and face painting for young children with a special appearance by Santa Claus.

Friday, 15th December at 12 noon – Cóisir na Nollag at Charlemont Court, Charlemont Mall. Irish storytelling session for the Irish language walking group with chat and Christmas refreshments.

Friday, 15th December at 2pm - Terenure Christmas Tea Dance at the Evergreen Centre. Festive event for older people with live music from the band, Pastimes.

Friday, 15th December at 2.30pm - Un Petit Reunion De Noel at Charlemont Court, Charlemont Mall. Christmas get-together for the French language walking group with chat and refreshments.

Saturday, 16th December at 4pm – Christmas Carols at St. John the Evangelist Church, Sandymount.

Tuesday, 26th December at 12pm – The Wren Boys' Day in Sandymount Village. Family event with traditional music, poetry and dance.

Weekly Activities:

Every Monday from 2-3.30pm – **Maxwell Court Art Classes** at Maxwell Court, Rathmines.

Every Tuesday at 11am – **Dance for Life** dance classes for older people at the Evergreen Centre, Terenure.

Every Tuesday at 2pm – **Let's Walk & Talk** walking group, meeting outside the Barge Pub, Charlemont Street.

Every Wednesday at 11am – Chair Yoga for older people at Beech Hill Court, Donnybrook.

Every Wednesday at 2pm – **Let's Walk & Talk in Spanish** walking group, meeting at Kildare Place, Kildare Street.

Every Thursday at 10am – **Parent & Toddlers' Group** at the Evergreen Centre, Terenure.

Every Thursday at 2pm - **Let's Walk & Talk** walking group, meeting at Sandymount Green.

Every Thursday from 3-5pm – **Knitting classes** at Beech Hill Court, Donnybrook.

Every Friday at 11am - **Let's Walk & Talk as Gaeilge** walking group, meeting at Meeting House Square, Temple Bar.

Every Friday at 11am - **Let's Walk & Talk in French** walking group, meeting at Kildare Place, Kildare Street.

Every Saturday at 2pm - **Let's Walk & Talk** walking group, meeting at the car park of the Dropping Well Pub, Milltown.

The above weekly activities will be taking a break over Christmas so please check with each group for details.

The South East Area Community Team would like to take this opportunity to acknowledge and thank all the groups and volunteers involved in the above and to wish them all a very Happy Christmas.

To the Chairperson and Members of the
South East Area Committee

Environmental Services Unit Report

Leaf Collection

Leaf collection is continuing throughout the south east area, and is nearing completion for this year. There was an increase in the number of groups, associations and particularly individuals working in their own areas involved in the leaf clearing initiative. The South East Area Office is providing bags and equipment and arranging for the removal of the collected bagged leaves.

Artwork

A total of 28 traffic light boxes have been completed throughout the south east area in 2017. Art work on a container on Sandymount Strand is unfortunately taking far longer than anticipated, due to wind conditions, the proximity to parked cars and the indented surface on the boxes themselves. Earlier trials with a different paint did not work out. However, on completion, the position as regards the rest of the containers will be reviewed in Spring 2018, when weather becomes suitable again for this type of outdoor art work.

**To the Chairperson and Members of the
South East Area Committee**

Housing Projects and Local Area Improvements

Grand Canal Sub Group

The latest meeting of the Grand Canal Sub-committee was held on 11th October 2017. 21st April 2018 identified as potential date for Canals Action Day. Waterways Ireland is developing a new Dublin Canals website to incorporate both canals in the city. Work is ongoing on a pilot Canal Warden scheme. The date of the next meeting of the Grand Canal Sub-committee has yet to be decided.

Rathgar Village Improvement Plan (VIP)

The finalised Rathgar Village Improvement Plan (VIP) was approved at the January 2015 South East Area Committee. The Part 8 was approved at the meeting of the City Council on 9th January 2017. Implementation works has commenced with re-alignment of the bring centre by Waste Management Section. Consultation was carried out with three local primary schools in relation to providing a nature play area in the woodland area. Tenders have now been returned and initial tree works have commenced and works to the nature play area will start in December 2017. Parks Services will make a short presentation on the consultation process at the January 2018 South East Area Committee.

Ranelagh Gardens Park

The Part 8 was approved by the City Council in July 2015. The playground has now been completed. Other elements of the Part 8, including a bird garden, planting, works to pond edging and island will be carried out in November and December 2017.

Ringsend Irishtown Local Environment Improvement Plan (LEIP)

The Ringsend Irishtown Local Environment Improvement Plan was adopted at the June South East Area Committee. Work will begin on preparation of a Part 8 planning application in relation to Library Square and Cambridge Road later in 2017/ 2018.

Terenure 2030

In 2016 six new lamp standards were provided in the village along with cycle parking and new litter bins. A further five new lamp standards have now been identified and the Public Lighting Section has placed an order for same, to be installed in early 2018.

Charlemont

French Mullen House is complete. The tenants of Tom Kelly Road have taken up occupation with the remaining tenants scheduled to move this week. Practical completion on Phase II (external paving and the community centre fit-out) has been achieved.

Crampton Buildings

The Law Department is completing the formalities for the new lease at Crampton Buildings together with the acquisition of the courtyard. We are working to resolve some issues with the wetroom in Unit 3.

GB Shaw House.

Following the Arts and Culture SPC meeting in November 2017 the Development Department advised that we have all the required documents to acquire the lease from the National Tourism Development Authority. We need to clarify with the Law Department and potentially with the property owner that there is nothing in the lease which would prevent us from carrying out any of the proposed works or from putting the building to the intended use.

To the Chairperson and Members of the
South East Area Committee

Dublin City Sport and Wellbeing Partnership (DCSWP) Report

- The **Lord Mayor's 5 Alive Challenge** is back for 2018! The initiative is a partnership programme between Dublin City Sport & Wellbeing Partnership and the Lord Mayor's Office. The challenge is in its 6th year and has encouraged hundreds of people to take up regular exercise over the past 5 years.

In 2018 we are going back to our roots and are looking for people who are interested in taking up jogging or those who have started and need some encouragement to keep it going. For 2018, we have also introduced mentors - people who have completed the challenge in previous years and who will run with slower joggers / walkers and encourage them around the course.

The challenge is to complete 5 Dublin road races –
[Tom Brennan Memorial 5k New Year's Day Road Race](#) on 1st January
[AXA Raheny 5](#) on 28th January
[BHAA Garda Cross Country 2 Mile / 4 Mile](#) on 3rd February
[MSB St. Patrick's Festival 5k Race and Family Fun Run](#) on 18th March
[BHAA Dublin City Council](#) 10k race on 7th April

If for some reason someone can't complete one of these races, they can substitute for one of the parkruns organised by [Parkrun Ireland](#). Priority will be given to first timers and we also ask that people who can complete a 5k in under 30 minutes do not register for the challenge and leave the spaces for those who need the support.

- **Men on the Move**
This is a FREE physical activity programme aimed at adult men who have been inactive for a sustained period and want to get back to exercising and improving their fitness levels. It involves twice weekly exercise sessions made up of a combination of aerobic, strength & flexibility components.

The 12-week programme (finishes mid December) is currently running in St. Joseph's Parish Hall, Terenure Road East, on Tuesday evenings at 7pm and also in the Evergreen Centre, Terenure Road North, on Thursday evenings at 7pm. This programme is a joint initiative between the HSE Health Promotion & Improvement Officer, David Phelan, and the local DCSWP Sports Officer, Michelle Malone. For further details or to sign up please contact David on 01-2227734/087-6525001 or david.phelan6@mail.dcu.ie

- **Change for Life**
This is an 8-week programme which targets underactive adults. The aim of the programme is to establish a group that will support each other in participating in weekly fitness sessions organised by DCSWP Sport Officers. The 4 weekly sessions

will include activities such as boxfit, aerobics, step classes, walking, running etc. in addition to educational aspects.

It is hoped that the group, once established, will take part in citywide marquee events such as the Operation Transformation Walk on 6th Jan (and run on 17th Feb) & also an end of programme celebration event in the Mansion House at the end of March. The programme is planned to be delivered from Irishtown Stadium. Registration for the programme will be from Monday 11th December to Friday 15th December at the stadium.

- **Couch to 5K**

A *Couch to 5K* programme is ongoing in Ranelagh. The runs are open to the general public and set off from Ranelagh Village every Monday evening at 6pm. The group is hoping to participate in their first park run on Saturday, December 16th.

Couch to 5K programmes are a partnership between the DCSWP Sports Officer, local schools or organisations, Parkrun and Athletics Ireland.

A running group has commenced every Tuesday evening at 4.30pm with staff from St. Vincent's Hospital. The group have completed the *Couch to 5K* Programme and are now working on 5k – 10k.

- **GAGA (Getting All Girls Active)**

This is a 6-week sports programme for teenage girls from local schools. The programme content will be decided in consultation with the girls in an attempt to optimise participation. Suggested activities may include fencing, boxing, fun games, rugby, basketball, biking etc. There will be a citywide promotion of the programme on 13th December which will involve social media activation.

The following GAGA programmes are currently being delivered in the South East Area:

Zumba with 2nd year students from St. Louis High School, Rathmines, every Monday & Thursday.

- **Get Dublin Walking**

This is an initiative funded by the Department of Health which aims to achieve one of the key points of the Healthy Ireland Strategy. Get Dublin Walking consists of an 8-week programme which targets underactive adults to begin a walking programme as part of a group that meets on a weekly basis. It is envisaged that this group may begin with the Operation Transformation Walk on January 6th. Preparatory work is currently being undertaken by the DCSWP Sport Officer to identify a group of eligible participants within the D2 & D4 areas.

- **Dance for Life**

Dance classes for older adults take place at the Evergreen Centre in Terenure every Tuesday at 11am. Classes are €4 per session and a great way to meet new people and keep fit.

- **Forever Fit**

Chair fit classes continue every Thursday morning at 10.30am in the Enterprise Centre, Terenure and every Monday evening at 7pm in Mount Drummond Court, Harold's Cross. Classes are aimed at older adults in the area and generally run for 6 week blocks.

Two further Forever Fit programmes operate each week in the Ringsend / Irishtown area. The programme involves a range of physical activities for older adults. Activities include Go for Life Games, Tai Chi etc. The programmes are run as a partnership between the DCSWP Sport Officer and the Active Retirement Groups.

- **Thrive**

Thrive is a programme geared towards engaging people with mental health difficulties. This can range from people who suffer with anxiety or depression right through to people who may have suffered an acquired brain injury and need assistance in re-integrating into their communities from a personal independence, social & general wellbeing viewpoint.

The programme links with participants from Headway Ireland and introduces yoga over eight weeks so that participants can gain a basic understanding. Classes can contribute towards an improvement in the participants' mobility & range of motion and also help increase confidence levels.

- **Community Soccer Programme**

Access to Dublin City Council (DCC) Irishtown Stadium will be supported by the local DCSWP Sport Officer through links created with local stakeholders. Currently Ringsend Youth Service, Ringsend College and Roslyn House Rehab service are all being facilitated to use this fantastic DCC facility.

- **After School Programme**

An after-school sports programme will continue in December with St. Patrick's National School. The programme takes place on Thursday afternoons and encourages pupils to get more active and while supporting educational development.

Sport & Fitness Markievicz

- **Learn to Swim:** Children's swimming lessons are ongoing. Classes take place each Monday, Wednesday, Thursday & Friday at 3.15pm & 4.15pm. A swimming gala will be held on Wednesday, December 20th, from 3pm – 5pm for all the young people who participated in the swimming lessons.
- **Aquaphysical Classes:** Sports & Fitness Markievicz proudly announces the roll out of these classes, the first fitness centre in Ireland to do so! Classes take place on Tuesday lunchtimes & Wednesday evenings. Please contact the centre directly for more details.
- **Pilates:** New classes now taking place every Tuesday, Thursday & Friday. Please contact the centre directly for more details.

Football

- **Sprog Soccer:** This initiative for 4 – 8 year olds takes place every Friday morning in Sports & Fitness Irishtown (currently 60 participants) and every Wednesday at 9.30am in YMCA Aungier St (currently 80 participants).
- **Men's League:** Ongoing every Monday & Wednesday evenings from 6pm to 8pm in Ringsend Park.
- **Football for All:** This programme is aimed at young people with learning difficulties and / or physical disabilities and takes place in Irishtown Stadium on Fridays 5pm – 6pm. There are currently 15 participants.

- **Soccer Sisters:** The initial 6-week intro programme for girls from various primary schools is now drawing to a close and will re-commence in the New Year.

Rugby

- Our DCSWP/Leinster Rugby Development Officer is continuing to deliver primary & secondary school programmes in the South East Area. The Primary Programme consists of weekly tag rugby sessions and is aimed at 4th, 5th & 6th class pupils.

The secondary programmes (targeting both boys & girls schools) commence with tag sessions for transition year students, eventually leading to full contact 7 or 10-a-side matches. This transition will occur once participants have familiarised themselves with the rules, skills & tackling technique etc. required to be able to play the game in a safe manner.

Rowing

- **Get Going ... Get Rowing**

This initiative, jointly supported by DCSWP, Sport Ireland, Healthy Ireland, Active School Flag & Trinity College, has been successfully rolled out for a number of years by Rowing Ireland's Leinster Women's Development Officer, Michelle Carpenter. This is a rolling 4/6 week school's programme for girls (second level). Rowing Ireland provide rowing machines and a community coach to the schools.

A further transition year programme gives students the opportunity to get on the first step of the coaching ladder and enables them to be involved in a youth leadership role, working in a fun and interactive environment with younger students and hence, bringing value to the school.

- **Olympic Values Education Programme (accompanies above programme)**

Students will be taught values such as fair play, respect, dignity etc... through rowing. *Get Going ... Get Rowing* will be the first programme in Ireland to roll this out. School's partaking in this include-

- *Presentation College, Terenure*
- *Our Lady's School, Templeogue Road, Terenure*
- *High School, Rathgar*

Boxing

- The DCSWP / Irish Amateur Boxing Association (IABA) Boxing Development Officers will visit many of the local schools in the South East Area with an Olympic presentation (including an actual Olympic medal & torch). This will take place during the two weeks leading up to the Christmas break.
- In January the Bronze Start-Box Programme will kick off once more with primary and transition year students. The bronze programme runs for 4 weeks and targets approx. 6 – 8 schools in the area.
- Weekly fitness sessions are ongoing for a teenage girls' group and a young men's group aged 18-25 years that currently engage with the local youth service. During the planning stages of the programme, participants decided that boxing would be the activity of choice. The facilities at St. Andrew's Resource Centre are used and

participants are able to benefit from the expertise of the DCSWP / IABA Boxing Development Officer.

The programme will run as a partnership between the DCSWP Sports Officer, St. Andrew's Resource Centre, local youth service and the IABA / DCSWP Boxing Development Officer. It is an aim of this programme that participants may progress to join the recently established 'Ringer' Boxing Club.

- The DCSWP / IABA Boxing Development Officer will continue to work with Roslyn Park College (promoting mental health) and the Spellman Centre (for people with addiction issues) in 2018.

Cricket Development Officer Report

- Our Cricket Development Officer is liaising with DCSWP Sports Officers in the area to plan programmes for the coming months.
- School coaching visits continue in Star of the Sea Boys' National School on Wednesdays and St. Matthew's National School, Sandymount, on Mondays.
- Our annual Dublin City U12, U14 & U17 Christmas and New Year Camps will be taking place on the 27th and 28th of December and the 3rd and 4th of January respectively in North County Cricket Club from 10am - 4.30pm. We will have participants from all over Dublin City, including the South East area.

Contact details:

Antonia Martin, DCSWP Programmes & Services Development Manager:

antonia.martin@dublincity.ie

Alan Morrin, Acting Senior Staff Officer, DCSWP: alan.morrin@dublincity.ie

Michelle Malone, Sports Officer: michelle.malone@dublincity.ie

Maz Reilly, Sports Officer: marielouise.reilly@dublincity.ie

Aideen O'Connor, Sports & Fitness Markievicz & Irishtown: aideen.oconnor@dublincity.ie

Football: jonathan.tormey@fai.ie

Rugby: ken.knaggs@leinsterrugby.ie

Boxing: michael.carruth@dublincity.ie

Cricket: fintan.mcallister@cricketleinster.ie

Report by:

Alan Morrin

Dublin City Sport & Wellbeing Partnership

**Housing, Community & Emergency Services Department
South East Area Office**

**To the Chairperson and Members of the
South East Area Committee**

**Naming and numbering proposal for new development on a site at Mount Tallant
Avenue, Terenure, Dublin 6W**

Ascaill San Pancras / St. Pancras Avenue
Teach San Pancras / St. Pancras House

A request has been received from Leopold Square Ltd. to name and number a development at Mount Tallant Avenue, Terenure, Dublin 6W, St. Pancras.

The applicant has chosen the name St. Pancras for the development. The name St. Pancras Avenue is proposed for the houses which will be numbered 1- 36 and the name St. Pancras House for the apartments which will be numbered 1 – 30.

The rationale for the chosen names includes that the 1878/1882 editions of the Ordnance Survey identify a house on the site as St. Pancras House and a later the site was redeveloped as a confectionary company facility and became known as St. Pancras Works. The entrance to the site is a protected structure listed under the name St. Pancras Gates.

The development is indicated on the drawing S.M. 2017-0640.

The Heritage Officer considers the proposed names appropriate and accordingly the scheme is recommended for approval.

**Rose Kenny
Area Manager**

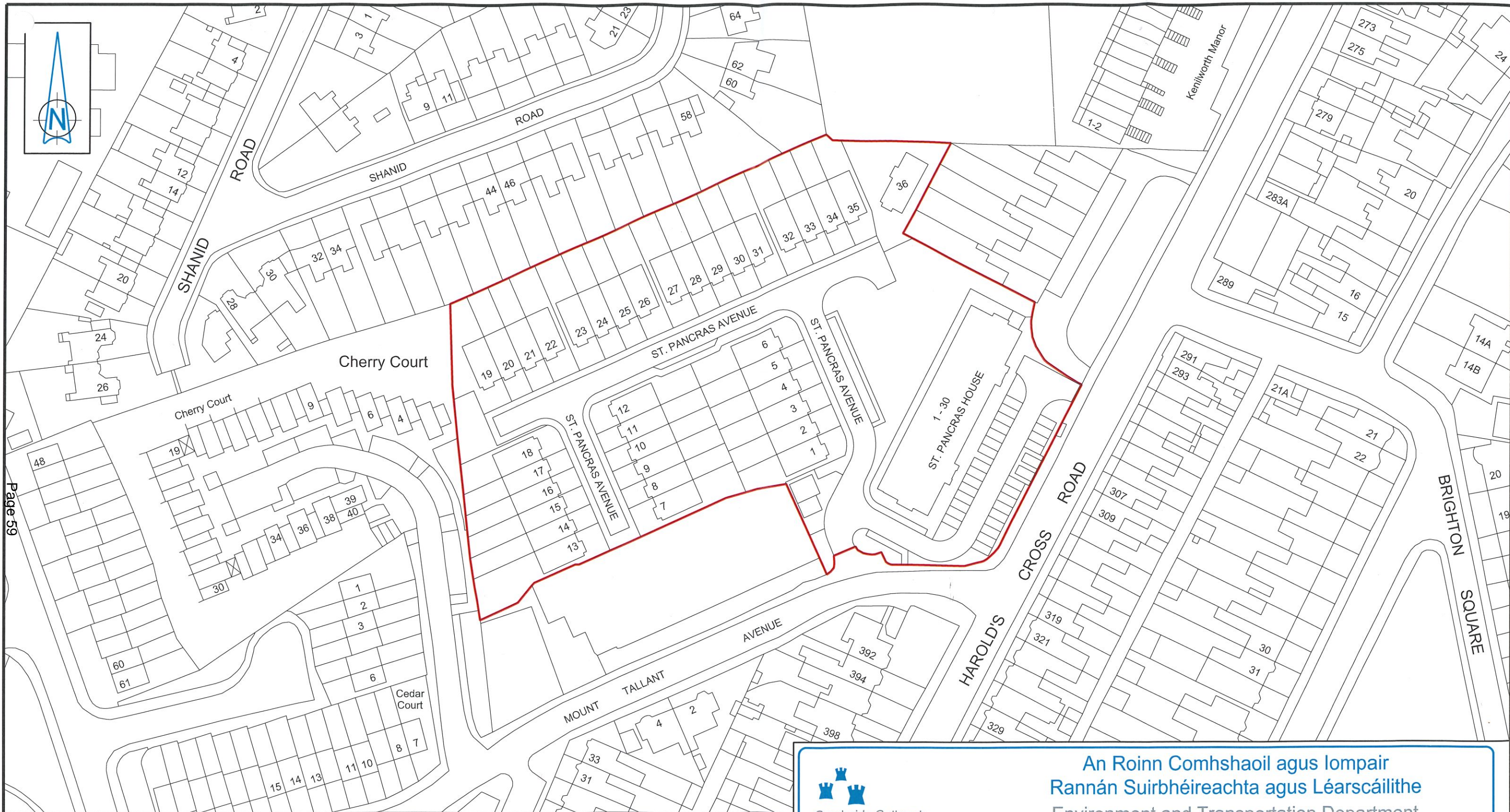
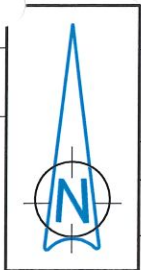

ST. PANCRAS AVENUE & HOUSE

Map for Naming and Numbering



Comhairle Cathrach
Bhaile Átha Cliath
Dublin City Council

An Roinn Comhshaoil agus Iompair
Rannán Suirbhéireachta agus Léarscáilithe
Environment and Transportation Department
Survey and Mapping Division

O.S REF
3328-09

SCALE
1:1000

INDEX No FOLDER No CODE DWG No REV
FILE NO SM-2017-0650-0204- C23 - 001 - A.dgn

DATE
24-10-2017

SURVEYED /
PRODUCED BY
T. Curran

THIS MAP IS CERTIFIED TO BE COMPUTER GENERATED BY
DUBLIN CITY COUNCIL FROM ORDNANCE SURVEY DIGITAL MAPBASE
SURVEY, MAPPING AND RELATED RESEARCH APPROVED

JOHN W. FLANAGAN
PhD CEng Eur Ing FIEI FICE
ACTING CITY ENGINEER

APPROVED
THOMAS CURRAN
ACTING MANAGER LAND SURVEYING & MAPPING
DUBLIN CITY COUNCIL

INDEX No.
SM-2017-0640

**Housing, Community & Emergency Services Department
South East Area Office**

**To the Chairperson and Members of the
South East Area Committee**

**Naming proposal for the building formerly occupied by the Central Bank of Ireland at
44 – 45 Dame Street, Dublin 2 and associated plaza to the south.**

**1 An Plaza Láir / 1 Central Plaza
An Plaza Láir / Central Plaza**

A request has been received from Virtus Project Management, 5th Floor, The Glass House, 11 Coke Lane, Smithfield, Dublin 7 to rename the building formerly occupied by the Central Bank of Ireland at 44 – 45 Dame Street, Dublin 2 and to name the associated plaza to the south of that building.

The applicant has chosen the names “1 Central Plaza” and “Central Plaza” for the following reasons:

“...it is respectfully submitted that the proposed name, 1 Central Plaza, has particular significance having regard to the central location of the site, its association with the former use (Central Bank of Ireland), and the prominence and importance of the building...”

“...it is respectfully submitted that the proposed name Central Plaza, has particular significance having regard to the central location of the site and its association with the former use of the building to which the plaza relates (Central Bank of Ireland).”

The development is indicated on the drawing R.M. 36859.

The Heritage Officer considers the proposed names appropriate and accordingly the scheme is recommended for approval.

**Rose Kenny
Area Manager**

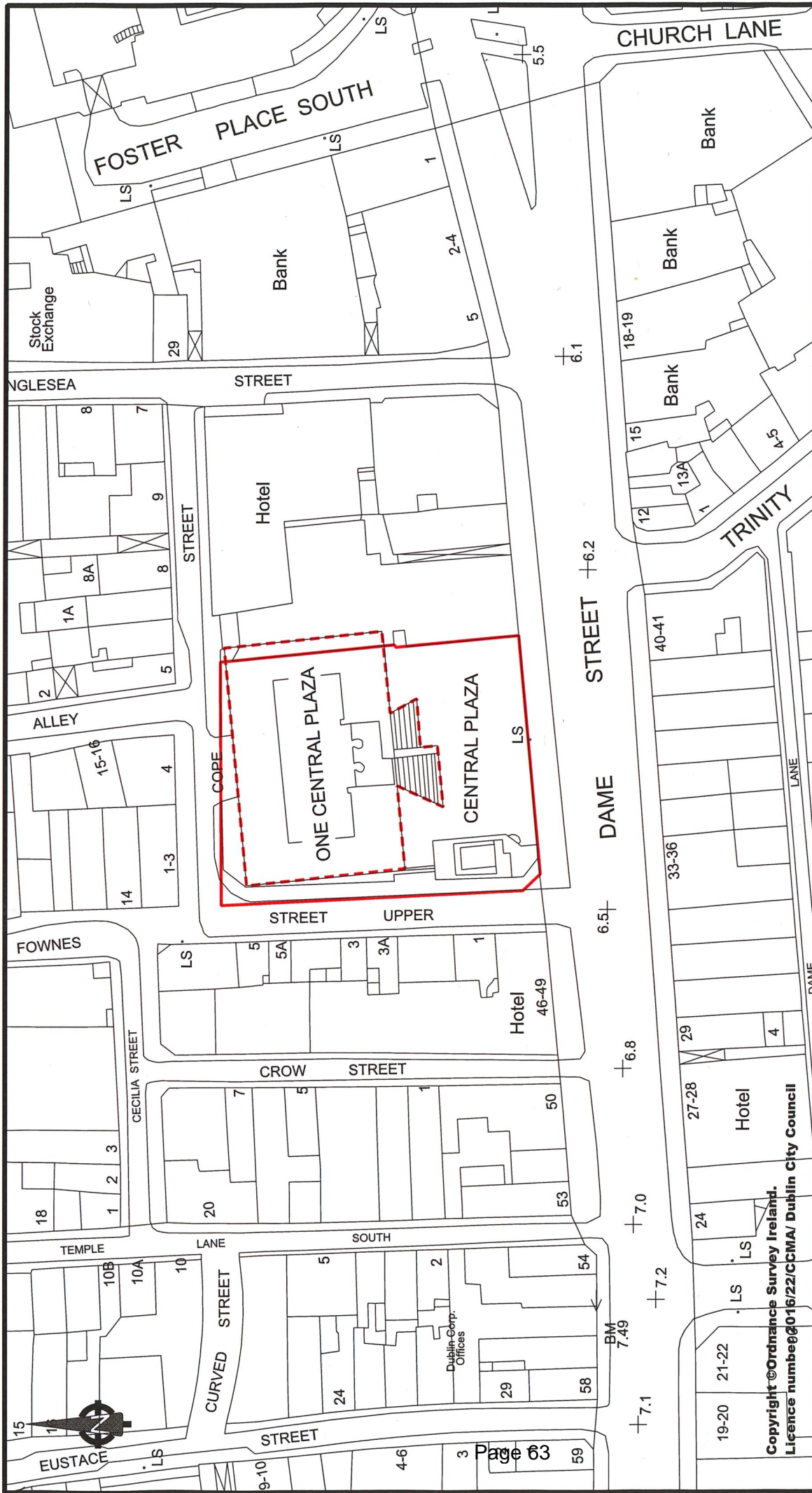

'One Central Plaza'
'Central Plaza'
 New development at Dame Street, D.2.

REFERENCE DRAWINGS	DATE
	//20
	//20
	//20

REVISION	DESCRIPTION	DATE

Comhairle Cathrach
Bhaile Átha Cliath
Dublin City Council

ENVIRONMENT & TRANSPORTATION DEPARTMENT,
 CIVIC OFFICES,
 WOOD QUAY, DUBLIN 8.

John W. Flanagan
 PhD CEing Eur Ing FIEI FICE
 Acting City Engineer

ROADS MAINTENANCE DIVISION

SCALE 1:1000
 DATE 23/10/2017
 DRAWING No. R.M. 36859

Copyright © Ordnance Survey Ireland.
 Licence number 016/22/CCMA/ Dublin City Council

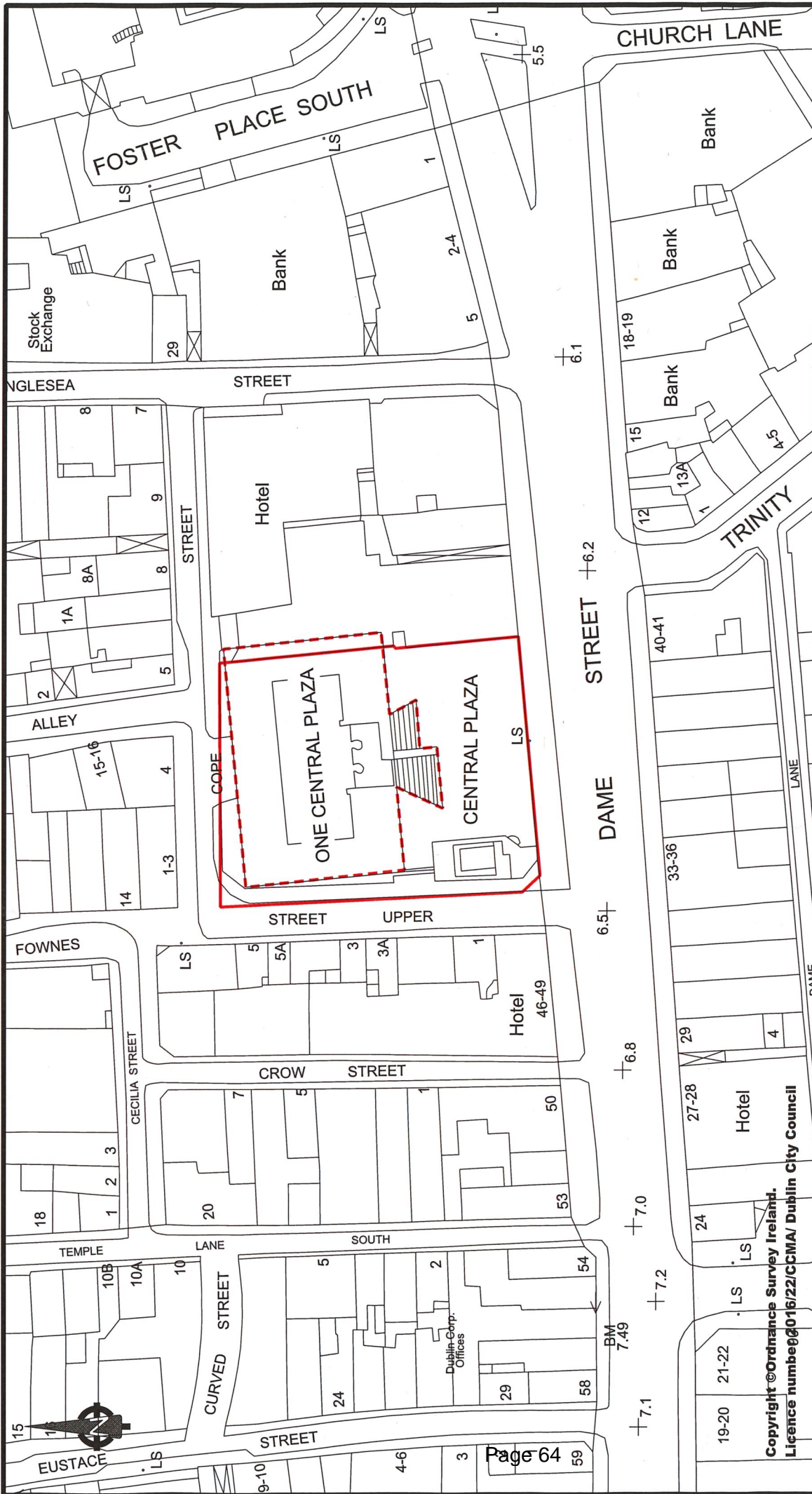

'One Central Plaza'
'Central Plaza'.
New development at Dame Street, D.2.

REFERENCE DRAWINGS	DATE	DESCRIPTION	REVISION
	//20		
	//20		
	//20		

ROADS MAINTENANCE DIVISION

Comhairle Cathrach
Bhaile Átha Cliath
Dublin City Council
 ENVIRONMENT & TRANSPORTATION DEPARTMENT,
 CIVIC OFFICES,
 WOOD QUAY, DUBLIN 8.

John W. Flanagan
 PhD CEing Eur Ing FIEI FICE
 Acting City Engineer

SCALE 1:1000
DATE 23/10/2017
DRAWING No. R.M. 36859

Copyright © Ordnance Survey Ireland.
Licence number 016/22/CCMA/ Dublin City Council

Motions

Motion 1 from Councillor Claire Byrne

(Carried from the November South East Area Committee meeting).

That this area committee agrees that the Pigeon House site and adjacent buildings and land owned by Dublin City Council will be used only for community, cultural, creative and artistic purposes, and that Dublin City Council will actively pursue the development the Pigeon House site as a community, creative and artistic cluster and will work in collaboration with suitable partner (s) and in consultation with the Arts Office, Arts and Culture Recreation SPC and the area committee and Dublin City Council and that the area committee will not support any development proposals that do not adhere to the above.

Motion 2 from Councillor Dermot Lacey

This committee requests the manager to prepare a plan to repair and restore the heritage lighting on the bridge at Ballsbridge perhaps in conjunction with the final flood relief works at that location.

Motion 3 from Councillors Mary Freehill, Ruairí McGinley, Anne Feeney, Claire O'Connor, Paddy Smyth and Patrick Costello

Following a very well attended meeting of residents from Upper and Lower Mount Pleasant Avenue along with Bessborough Parade, Richmond Hill & Place and Gulistan; the residents very clearly pointed out that the volume of traffic now moving through Upper and Lower Mount Pleasant Avenue is unsustainable and is severely interfering with the ability of people to live there. This is a very narrow road that was never intended to cater for this volume of traffic; it's now dangerous for residents and especially children. We as elected councillors for the area collectively propose that a "traffic calming study" be urgently carried out for Lower & Upper Mount Pleasant Avenue to deal with the pressing issue of heavy volume of traffic.

- (a) As a first step that a 3 ton truck limit be imposed on this route
- (b) That Mount Pleasant Ave Lower. and Upper be listed for byelaw amendment to make this area a 30 kmph speed limit

Motion 4 from Councillor Dermot Lacey

That this committee asks the manager to initiate the inclusion of St. Mary's (former home and convent), Pembroke Park, Donnybrook, Dublin 4 on the list of protected structures.

Motion 5 from Councillor Dermot Lacey

This committee requests the manager to contact Eircom (or whatever it is called now) to remove the unwanted and no longer in use for their intended purposes phone boxes at the corner of Richmond Street South and Harrington Street. Picture below of phone boxes outside AIB bank corner of Richmond Street South and Harrington Street. Anyway, these phone boxes aren't used as phone boxes much at all anymore. They've developed into an eyesore and are now dangerous if addicts are using them to inject.



Motion 6 from Councillor Sonya Stapleton

This committee calls on the manager to have a gate installed at the entrance to O'Carroll Villas flats car park.

Motion 7 from Councillor Sonya Stapleton

This committee calls on the manager to have a playground installed in Mercer House flats.

Motion 8 from Councillor Claire Byrne

That this area committee calls on the area manager to install a pedestrian crossing at the junction across Bishop Street and at the junction of Kevin Street and Bride Street. Crossing here is very difficult and dangerous for pedestrians and the new Garda Headquarters building is making it even more challenging.

Motion 9 from Councillor Claire Byrne

That this area committee calls on the area manager to clean and refurbish both the Patrick Kavanagh seat and the Percy French seat along the Grand Canal, and to consider relocating the bin beside the Patrick Kavanagh seat.

Motion 10 from Councillor Chris Andrews

That this area committee requests the Office of Public Works (OPW) make a presentation to area committee regarding the future plans for the Iveagh Gardens as previously requested?

Motion 11 from Councillor Mannix Flynn

That this committee calls on Dublin City Council (DCC) to rename Hume Street in honour of Mr. John Hume for his outstanding contribution to Irish political life and in particular his unique contribution to the peace process of Northern Ireland. This is a very simple process and can be initiated by DCC by way of plebiscite.

The street was named after the family of surgeon Sir Gustavus Hume. The street is undergoing many changes at the moment with the skin care hospital moving to St. Vincent's in 2006. There are hardly any residents in the street, it is mainly offices and head quarters. It would be appropriate to give the street a new lease of life in honour of John Hume. Sir Gustavus Hume: <https://theirishaesthete.com/2016/08/22/a-glimpse-of-the-past/>

Motion 12 from Councillor Mannix Flynn

That this area committee calls on Dublin City Council to treat the Proclamation of 1916 with respect and dignity that it deserves and afford it a permanent fixed position within the Rotunda of the City Hall.

Further, that a proper copy of the proclamation be commissioned perhaps by an artist as opposed to the ad hoc plastic stand alone lit-box that is being used in the Rotunda of the City Hall at the moment. At present the proclamation lit-box is thrown around the Rotunda depending on what event is happening. Last night it was dispensed with behind a load of catering and the light turned off. This is happening on a regular basis and it is unacceptable.

It is now time that the proclamation be given a permanent position on the walls of the Rotunda and that a proper copy of the proclamation be made. There was a motion passed at this committee last year that would see the removal of the Anne Madden triptych and the installation of the proclamation in that prominent place. The Anne Madden work has been in the Rotunda in City Hall for many years now and it could well do with being removed as there are many complaints about this work and the appropriateness of this work in this historic building.

Motion 13 from Councillor Mannix Flynn

That this committee of the South East Area agrees that no portraits or symbols other than the national flag and the flag of Dublin city should be permitted in the Council Chamber and that all portraits be removed as is best practice in other democracies. The Council Chamber should always be free of undue influences and at present the Council Chamber has many portraits, all male. This in itself is an act of inequality. These portraits should be removed perhaps to the Rotunda or be returned to the Hugh Lane Gallery where they would be much appropriate. A neutral chamber should always be our aim and our best practice.

Q1. Councillor Anne Feeney

To ask the manager what is the current situation with regard to bus routes which service the South East Area and previously routed around St. Stephen's Green before the work on the extended Green Line Luas commenced e.g. the 15, 15A, 15B, 140 and other routes. Will they continue on the routes they currently travel or revert to the routes they used to take around St. Stephen's Green and down Dawson Street?

Q2. Councillor Sonya Stapleton

To ask the manager to examine the concerns of a resident in O'Connell Gardens, Bath Avenue, Dublin 4, relating to a tree that is blocking most of the day light coming into her home. This old established tree outside her home needs to be pruned back and when she reported this to the Dublin City Council some time back she was told that this work would be done in autumn time.

Q3. Councillor Paddy Smyth

To ask the manager to increase the frequency of street cleaning on Temple Road, Dartry. Due to the high footfall to and from the Luas as well as the large amount of student accommodation in the area, the road is becoming increasingly littered.

Q4. Councillor Patrick Costello

To ask the manager to provide an update on the provision of CCTV for Maxwell Lane to prevent dumping and anti social behaviour. This was requested at the October meeting and the manager agreed to examine this possibility.

Q5. Councillor Dermot Lacey

Given that according to residents that their road has not been swept for years (never mind the promised every 12 weeks) that the manager would arrange for an immediate thorough cleaning of Morehampton Lane, Donnybrook.

Q6. Councillor Dermot Lacey

That the existing confusing "Cul de Sac" sign at the entrance to Morehampton Lane, Donnybrook be relocated so that it clearly refers to that lane.

Q7. Councillor Dermot Lacey

To ask the manager if she would arrange for the road sweeping as requested in the email submitted with this question to be carried out as soon as possible. As the manager should note the representative of the residents has agreed to liaise with other residents to arrange to have cars moved to make the job easier to carry out.

Q8. Councillor Chris Andrews

Can the manager request that Dublin Bus move the bus stop from directly outside *details supplied as the stop is right outside this person's front sitting room window and it means the resident is unable to open the window because of noise and pollution from the bus and she has a heart complaint so it is having a negative impact on her health.

Q9. Councillor Paddy McCartan

Despite repeated requests to deal with the very uneven and dangerous road surface on Milltown Road at the pedestrian crossing adjacent to the church and Phelan's pharmacy there has been no action to have the matter rectified. Elderly people have stumbled and fallen trying to cross. The area needs resurfacing, not a patchwork job.

Can the manager give a date for resolution of this issue which was first reported almost two years ago?

Q10. Councillor Paddy McCartan

To ask the manager to arrange for a replacement bench to be installed along the causeway at the entrance to Irishtown Nature Park. The original bench was vandalised then set alight and destroyed in October.

Q11. Councillor Paddy McCartan

To ask the manager to deal with the following issue from a constituent who has written the following to me:

"Over the last 12 months I have sighted single rats scurrying across the tarmac path in broad daylight on many mornings circa 10 to noon.

This would have become a common sight. Now the rats are out in pairs not far from being tame, eating whatever it is they find on the actual path!

The area worst affected from my encounters is the path around the Martello tower car park (middle car park). I am very concerned at how tame these now very plump rodents have become, they would be easy prey to a toddler or a buggy with any food. The numbers in recent weeks have increased greatly, maybe Ophelia disturbed some nests. Please get something done about this problem ASAP. They seem to be breeding like wildfire, may even be being fed by well intentioned ill informed members of the public. I have tried DCC directed to HSE, redirected to Dublin City Council....Parks Dept, listened to concern at use of poison on the wildlife in the area. As for the health threat to any homeless person taking refuge here day or night!"

Q12. Councillor Paddy McCartan

On the 50th anniversary of the death of Patrick Kavanagh could his seat on the Grand Canal be cleaned and refurbished? Also the Percy French seat on the opposite side of the lock needs similar attention.

Q13. Councillor Paddy McCartan

To ask the manager to place two big belly bins at Fitzwilliam Quay, Ringsend and along the Dodder walk way towards London Bridge, as this area has a direct connection with Aviva Stadium. There has been a huge growth in pedestrian traffic with the consequences of litter and nowhere to dispose of it.

Q14. Councillor Paddy McCartan

To ask the manager to arrange for the replacement of two litter bins that were removed about a year ago. They were located at the dart station at Sydney Parade and adjacent bus stop on Ailesbury Road.

Q15. Councillor Paddy McCartan

To ask the manager to respond to the various concerns of a constituent as set out below.

"I'm a resident of Pigeon House Road. I'm concerned about the proposed traffic route to service the new housing development planned for the old Glass Bottle site. The reason for my concern is that for no's [1-51 Pigeon House Road](#) already face onto 2 roads: the Pigeon House Road itself which is narrow and accommodates 2 lanes of traffic, and on the other side of the wall the toll bridge road with another two lanes of traffic.

Last year we heard that Dublin City Council are planning a public transport bridge 'Poolbeg Bridge' over the River Dodder at the end of the Pigeon House Road which

will have a dedicated public transport route (2 bus lanes and 1 cycle). The designs as yet have not extended into the wider road network.

I understand there is also the possibility of a LUAS extension from the Point Depot to the Irish Glass Bottle site running alongside the toll bridge road. Potentially this could lead to us moving from the current situation of 4 lanes of traffic to 8!

Let me add this is not a case of nimby-ism. I am delighted the glass bottle site is being developed given the housing shortage in Dublin. It will be a brilliant addition to the area. It should be noted though that the residents of Pigeon House Road have accommodated an incinerator, a large sewage plant, the Ecocem plant and a scrap metal recycling plant at the opposite end of Pigeon House Road with the attendant heavy goods traffic down Sean Moore Road so we put up with a fair bit already!

I would be grateful if you could take my concerns on board and advise me if there is any mechanism whereby my concerns and those of my neighbours about the risk of 4 x car lanes 2 x bus lanes 1 x LUAS and 1 cycle lane all within 25 feet of our houses can be avoided. If there is a process by which a formal objection can be lodged I would be grateful if you could let me know."

Q16. Councillor Chris Andrews

Can the manager address the issues in the attached email (details supplied)?

Q17. Councillor Mary Freehill

Would the manager please state what action is being taken to repair the turn right filter from Harold's Cross Road to Grove Road? The filter has only been working on an inconstant basis. On many occasions even when a car is in the box the filter light doesn't work. This is causing major tail backs on Harold's Cross Road and I have reported on numerous occasions over the past year.

Q18. Councillor Mary Freehill

When can the residents of O'Hara Avenue expect to receive extension of parking times? They made application earlier this year.

Q19. Councillor Mary Freehill

What steps have been taken to prepare the traffic calming scheme for Corrib Road and Mount Tallant Avenue area that was unanimously agreed by the area committee on two occasions over the past year?

Q20. Councillor Sonya Stapleton

To ask the manager when ground work is to commence on the court yard at the front of O'Carroll Villas flats?

Q21. Councillor Sonya Stapleton

To ask the manager to examine the concerns of a resident in O'Connell Gardens, Bath Avenue, Dublin 4, relating to a tree that is blocking most of the day light coming into her home.

Q22. Councillor Sonya Stapleton

To ask the manager to indicate how often York Street flats court yard is swept and cleaned with detergent. Residents have reported that the flat complex is filthy.

Q23. Councillor Sonya Stapleton

To ask the manager to get some indication from contractors that are doing the work on void *details supplied as to when works will be completed. This flat has been

vacant for at least seven months now. I have been told the contractor collected keys a couple of months ago. However, I also had reports that there has been no one on site in weeks. The lady that is to move into property is waiting and very unsettled as she has no indication of when this will happen.

Q24. Councillor Sonya Stapleton

To ask the manager to have the area on Montague Lane foot path cleaned up (debris from a fire) also the car park adjacent to it at the back of O'Carroll Villas flats.

Q25. Councillor Sonya Stapleton

To ask the manager what the cost was to the council to have O'Carroll Villas flats car park patrolled by the NCPS in 2016 / 2017.

Q26. Councillor Claire Byrne

To ask the area manager if she can please consider giving an on street parking permit to *details supplied.

Q27. Councillor Claire Byrne

To ask the area manager can you please provide an update on the following housing developments:

- Longfields Homeless Accommodation
- Moss Street Development

Q28. Councillor Claire Byrne

To ask the area manager can she please provide the following lists:

- The number of void dwellings refurbished and reallocated in the South East Area in 2017
- The locations of the void dwellings refurbished and reallocated in the South East Area in 2017
- The number of void dwellings currently awaiting refurbishment and reallocation in the South East Area and the location of these

Q29. Councillor Claire Byrne

To ask the area manager for the number of social houses and apartments built in the South East Area in 2017 and to provide a list of the locations of such homes.

Q30. Councillor Claire Byrne

To ask the area manager if she can please address the following issues affecting the residents of details supplied.

Q31. Councillor Claire Byrne

To ask the area manager for an update on the plans to improve conditions for cyclists at the junction of Nicholas Street, High Street, Winetavern Street and Christchurch Place.

Q32. Councillor Claire Byrne

To ask the area manager what options are available or what assistance can be provided for houses in areas identified as a flood risk for those who are experiencing difficulty in obtaining house insurance, despite flood works having been put in place.

Q33. Councillor Claire Byrne

To ask the area manager for an update on the progress of the completion of the Grand Canal Cycle way and to please outline the latest challenges to completing this vital cycle route for the city.

- Q34. Councillor Claire Byrne**
To ask the area manager what can be done to improve the condition of the trees on St Mary's Road, Dublin 4. These trees were pruned last year. However, they are still very dense and one tree was lost during the recent storm and another large branch also fell.
- Q35. Councillor Chris Andrews**
Can the manager have a presentation by planners of the application for a new hotel on Portobello Harbour before a decision is made?
- Q36. Councillor Chris Andrews**
Can the manager be lenient with the residents at details supplied?
- Q37. Councillor Chris Andrews**
Can the manager arrange to have the tree cut back as previously agreed in St. Andrew's Court which is overhanging the playground?
- Q38. Councillor Chris Andrews**
Can the manager have bait laid to tackle the increase in rats in details supplied?
- Q39. Councillor Frank Kennedy**
To ask the manager to repair the badly damaged footpath on Brendan Road, Donnybrook, especially outside No.2. Please see photo attached.
- Q40. Councillor Frank Kennedy**
To ask the manager to remove all sandbags which have been left by the council alongside and near the banks of the River Dodder opposite the Fitzwilliam Quay development.
- Q41. Councillor Frank Kennedy**
To ask the manager to address the following issues in respect of Arranmore Road, Donnybrook, Dublin 4:
(a) to prune the trees on Arranmore Road. At present residents have to walk on the road as the low lying trees at the top and bottom of the road are whipping their faces and blocking the path;
(b) To install double yellow lines at the end of Arranmore Road at the junction with Herbert Park because cars park at this junction, unaware that it is impermissible, and the turn has become extremely hazardous as a result due to reduced space and visibility;
(c) To remove the fallen leaves on Arranmore Road as a matter of urgency in circumstances where they have created a hazard on the road given the volume.
- Q42. Councillor Frank Kennedy**
Re DCC ref. *details supplied, to set out comprehensively what steps are required to be taken in order for the portion of Bushfield Avenue referred to in this correspondence to be taken in charge by Dublin City Council. If appropriate this question should be referred to Planning Department, Financial Contributions/Taking in Charge Section.
- Q43. Councillor Frank Kennedy**
To ask the manager to address the apparent breach of planning conditions as set out in this e-mail to me *details supplied.

Q44. Councillor Frank Kennedy

The residents of Pigeon House Road have accommodated an incinerator, a large sewage plant, the Ecocem plant and a scrap metal recycling plant at the opposite end of Pigeon House Road with the attendant heavy goods traffic down Sean Moore Road. There are serious concerns arising in respect of the following three infrastructural projects:

- (a) The proposed vehicular traffic route(s) to service the Poolbeg SDZ;
- (b) The proposed public transport bridge 'Poolbeg Bridge' over the River Dodder at the end of the Pigeon House Road; and
- (c) The possible Luas extension to the Poolbeg SDZ; and

It appears that there is a risk that residents may be asked to endure 4 x car lanes 2 x bus lanes 1 x LUAS and 1 Cycle lane all within 25 feet of their homes. As a result of this possibility, which is clearly unfair and unacceptable, to ask the Area Manager, in respect of each of these infrastructural proposals, the following:

- (i) What is the current state of each of these projects insofar as the planning process is concerned?; and
- (ii) What is to the precise avenue through which *and* the timeframe within which concerned local residents and elected representatives can make submissions on what is proposed?

Q45. Councillor Frank Kennedy

To ask the manager to relocate the bin beside the Patrick Kavanagh bench on the canal and to clean and refurbish both the Kavanagh and the Percy French commemorative seats. This is sorely needed in the case of both locations.

Q46. Councillor Frank Kennedy

To ask the area manager to produce a report on the quality of street lighting on Richelieu Park, which is very poor and in effect not fit for purpose at present, and to improve the volume and quality of lighting on this road.

Q47. Councillor Frank Kennedy

Repairs have recently been undertaken on Oaklands Drive, Sandymount. The effect of this is that the repair area has substantially subsided to the point that vehicles using the road are at serious risk of becoming damaged. There is surface water in the area. To ask the manager to rectify this as a matter of urgency.

Q48. Councillor Frank Kennedy

To ask the area manager to hold a ballot of residents on Brendan Road, Donnybrook, to extend the restricted parking hours from Monday-Friday to include Saturday in circumstances where the road is completely overtaken by parking on Saturday to the effect that residents cannot find a space.

Q49. Councillor Frank Kennedy

To ask the area manager to provide a report on the current status of and future plans for the pond at Herbert Park.

Q50. Councillor Chris Andrews

Can the manager say why funding was refused for Dublin City Community Cooperative?

- Q51. Councillor Chris Andrews**
Can the manager consider transferring *details supplied 1 to the vacant flat in number *details supplied 2 as his health is particularly bad and the transfer would make a big difference to the quality of their lives?
- Q52. Councillor Chris Andrews**
I would be grateful if the manager can advise residents if there is any mechanism whereby residents concerns about the risk of 4 x car lanes, 2 x bus lanes, 1 x LUAS and 1 cycle lane along the Pigeon House Road can be avoided. If there is a process by which a formal objection can be lodged I would be grateful if you could let me know and also what measure will be taken during construction phase and after to reduce the negative impact that huge increase in traffic will have on residents on Pigeon House Road, Cambridge Avenue and Poolbeg Quay?
- Q53. Councillor Claire O'Connor**
Can the manager arrange for a "Welcome to Rathgar" sign to be erected?
- Q54. Councillor Claire O'Connor**
Can the contract for tree cutting be extended to leaves collection?
- Q55. Councillor Claire O'Connor**
Can the footpaths on Hazelbrook Road be repaired and the street be cleaned?
- Q56. Councillor Claire O'Connor**
Can the sequencing of lights on Terenure Road West leading into Terenure Village be reviewed?
- Q57. Councillor Claire O'Connor**
Can a review of the parking on Oaklands Terrace be considered given that the parking on two sides is causing difficulty for pedestrians?
- Q58. Councillor Claire O'Connor**
Can the manager arrange for double yellow lines to be put down some of the way on both sides of the entrance to Meadowlands, Terenure in circumstances where people are causing a danger by parking just inside the corner? Additionally, with the parking so close to the corners it could create difficulties for a fire brigade or ambulance.
- Q59. Councillor Claire O'Connor**
Can a railing or bars be placed at the junction of Belgrave Square and Mount Pleasant in order to protect children waiting to cross? Alternatively, could speed ramps be installed to reduce the speed of motorists just before the lights?
- Q60. Councillor Claire O'Connor**
Can the trees in Lavarna be trimmed?
- Q61. Councillor Claire O'Connor**
Can the reasoning underpinning the placing of double yellow lines outside *details supplied be outlined and additionally any plans in place to remove them as they appear to have been put down without any explanation or consideration by this meeting?
- Q62. Councillor Claire O'Connor**
Can the branch on the tree across from the bus stop outside the synagogue in Rathgar be trimmed? And as you go towards Fergus Road from this location there is a tree lifting a footpath by three inches; can this be repaired?

Q63. Councillor Mannix Flynn

Can the manager issue a full report with regards the removal of phone boxes from the South East Area (SEA)? This report to include all phone boxes that have been removed from the SEA in the last year and the reasons why. And a list of all phone boxes that are to be removed in the future.

Q64. Councillor Mannix Flynn

Can the area manager issue a full report with regards the removal of all of the old JCDecaux advertisement boards within the South East Area? An agreement was reached with JCDecaux with regards the dublinbikes scheme and their new advertisement structures some years back. Part of that agreement was the removal of these ugly advertisement boards. There still remains a good few of these unsightly advertising boards attached to buildings such as Aungier Street see photos attached. It is time now for a full progress report in relation to this.

Q65. Councillor Mannix Flynn

Can the area manager request Waterways Ireland to remove the unsightly bin and the rubbish around it that is beside the Patrick Kavanagh seat on the Grand Canal at Baggot Street and relocate it to a much more appropriate setting. This part of the canal is also used for a fast food market and on many occasion this beauty spot and amenity is turned into a mess with the grass banks of the canal being eroded, noisy polluting generators, rubbish and all sorts of vehicles parked up onto the grass verge. It is unacceptable to allow such a unique public amenity to be degraded and overused in this way. It is badly managed and very dangerous as there is very little protection from the water. It also erodes access across the canal at this point for pedestrians.

Can a full report be supplied as to how this area can be better managed for the enjoyment of all?

Q66. Councillor Mannix Flynn

Can the manager investigate the possibility of two marked disabled parking spots to be designated for all social housing complexes within the south east area? A great many people who now reside in our housing complexes have varying degrees of disability. Some use cars of their own while many use taxis or are transported by relatives. It is almost impossible for people to find parking for loading, unloading and pick up. It is time now that Dublin City Council brought this whole issue up to standard and best practice and initiate a full examination of a possible roll out for such parking facilities. This is about inclusion, and equality.

Q67. Councillor Mannix Flynn

Can the area manager bring a full report to the South East Area Committee with regard to Tangier Lane which is adjacent to Grafton Street and exits up near Clarendon market? The Grafton Street end is blocked off by an unlawful gate and needs to be removed while the far end of the laneway which was in contention with regard to an extinguishing of right of way is now getting an entire new build. This report to include information on any change of use or ownership of lands at the laneway, the progress of the extinguishing of the right of way on that laneway, and Dublin City Council's responsibility for the management of this public area and laneway.

Q68. Councillor Chris Andrews

Can the manager also address the issue of fly tipping at entrance in Mount Angus at the bin at the entrance to the estate and that the bin is moved in further into the estate?

Q69. Councillor Mannix Flynn

Can the manager issue a full report and updates on the progress of the refurbishment of Verschoyle Court, Mount Street, Dublin 2? This report to include what estate management is in operation here, the hours of the opening and operations of the community centre and how many welfare visits have taken place to the tenants at this location?

Many of these dwellings are badly dilapidated and in poor condition. Many of our senior citizens and elderly are still living in these conditions, some without heating and other amenities. I was in the area recently visiting and I was shocked by the conditions of some of these dwellings. This is unacceptable in this day and age.

Q70. Councillor Mannix Flynn

Can the manager give us a fixed launch date for the Crampton Buildings apartment complex? This launch is long overdue and unacceptable and many tenants are pretty frustrated at the lack of any progress on this important issue for them.

Q71. Councillor Mannix Flynn

Can the manager have the street furniture section and the planning enforcement section visit a number of premises on Montague Street? This street and its footpaths are impassable with the amount of street furniture now fixed to the footpaths and walkways. This street is partly pedestrianised with traffic moving through it on a constant basis. Pedestrians and wheelchair users are constantly placed in danger as they have to move off the pedestrian area into oncoming traffic due to the fact that restaurants and cafes have commandeered the footpaths without any planning permission or street furniture licence. Equally the place is overrun with sandwich boards making this once fine street, a mess. Also many premises here are selling alcohol and it is not clear whether they are licensed to sell alcohol as there does not appear to be any license displayed.

Q72. Councillor Chris Andrews

Can the manager arrange to have double yellow lines on the first bend as you enter the Mount Argus View that leads onto Mount Argus Close as a number of people drive from outside the area and leave their cars there while they head into the city for the day?

